

# StoQuik® Silver DrainScreen™

## Wood Frame Construction

### Series 11.xx

January 2015

#### ATTENTION

Sto products are intended for use by qualified professional contractors, not consumers, as a component of a larger construction assembly as specified by a qualified design professional, general contractor or builder. They should be installed in accordance with those specifications and Sto's instructions. Sto Corp. disclaims all, and assumes no, liability for on-site inspections, for its products applied improperly, or by unqualified persons or entities, or as part of an improperly designed or constructed building, for the nonperformance of adjacent building components or assemblies, or for other construction activities beyond Sto's control. Improper use of Sto products or use as part of an improperly designed or constructed larger assembly or building may result in serious damage to Sto products, and to the structure of the building or its components.

STO CORP. DISCLAIMS ALL WARRANTIES EXPRESSED OR IMPLIED EXCEPT FOR EXPLICIT LIMITED WRITTEN WARRANTIES ISSUED TO AND ACCEPTED BY BUILDING OWNERS IN ACCORDANCE WITH STO'S WARRANTY PROGRAMS WHICH ARE SUBJECT TO CHANGE FROM TIME TO TIME. For the fullest, most current information on proper application, clean-up, mixing and other specifications and warranties, cautions and disclaimers, please refer to the Sto Corp. website, [www.stocorp.com](http://www.stocorp.com).

[www.stocorp.com](http://www.stocorp.com)



Property of Sto Corp.  
All Rights Reserved.

## Cement Board Stucco: StoQuik® Silver DrainScreen™

### Details Index

Description	Detail No.
System Components	11.01 DS
System Components – Alternate Drip Track	11.02 DS
“L” Bead Termination at Dissimilar Material	11.03a DS
Casing Bead Accessory at Dissimilar Material	11.03b DS
Control Joint Accessory (Face Mount)	11.03c DS
Control Joint Accessory (Back Mount)	11.03d DS
Foam Aesthetic Band/Projection (Thick)	11.04a DS
Foam Aesthetic Band/Projection (Thin)	11.04b DS
Termination at Sidewalk over Wood Frame	11.11 DS
Rough Opening Protection over Wood Frame	11.20a DS
Brick Mold Window Head	11.20b DS
Brick Mold Window Sill / Jamb	11.20c DS
Pan Flashing at Opening Sill	11.21a DS
Sill Flashing: Nail-fin Window	11.21b DS
Deck Flashing	11.32 DS
Termination at Soffit	11.40 DS
Floor Expansion Joint	11.50 DS
Joint at Inside Corner: Different Substrates	11.53a DS
Joint at Inside Corner: Common Substrate	11.53b DS
Outside Corner: Common Substrate	11.54 DS
Roof/Wall Diverter Flashing	11.62 DS
Saddle Flashing	11.65 DS
Foam Build-outs	11.70 DS

# StoQuik® Silver DrainScreen™ System Components

Detail No.: 11.01 DS

Date: January 2015

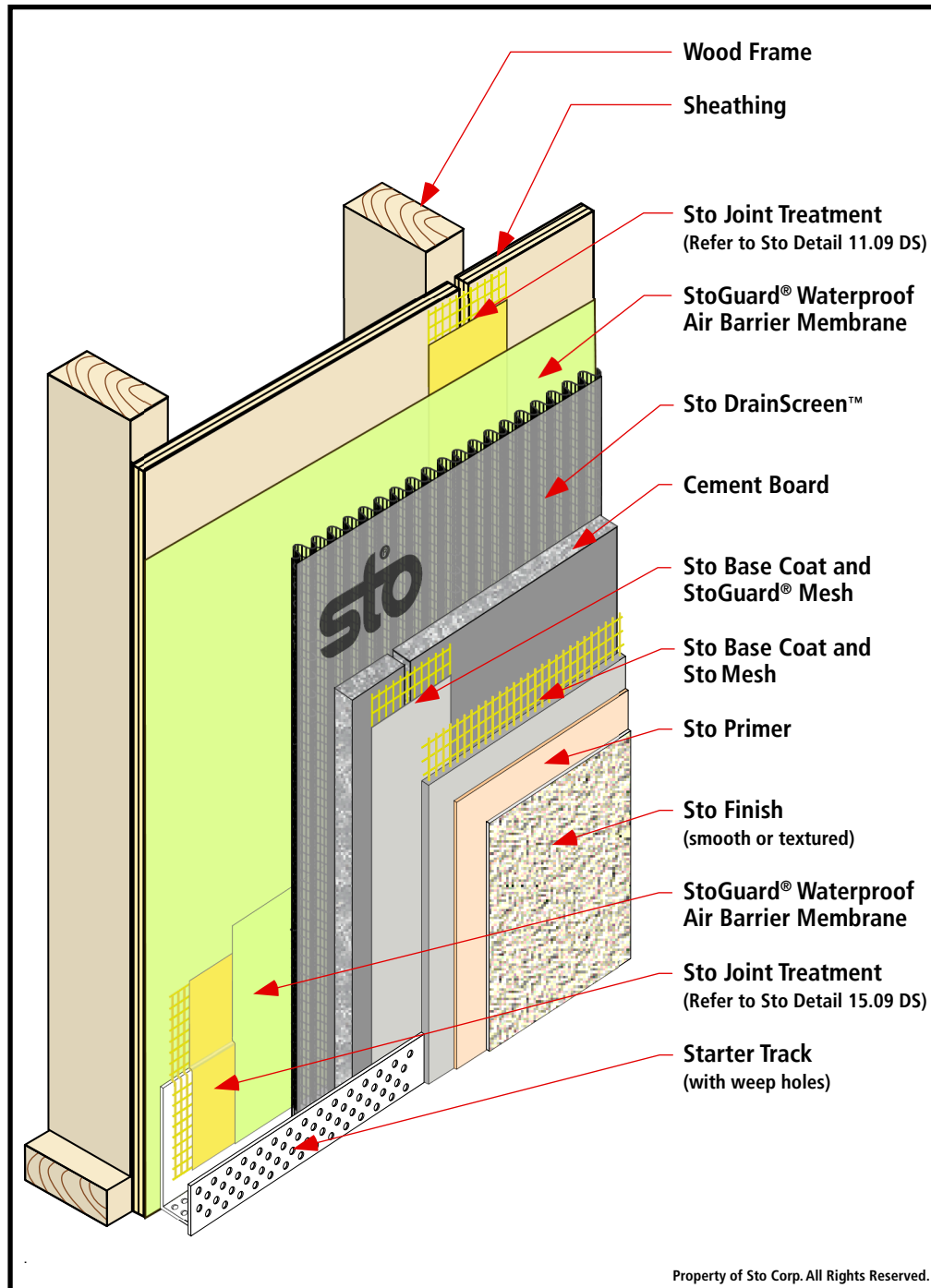

## Notes:

1. Detail shows the installation of StoQuik® Silver DrainScreen™ over a wood frame wall.

## Sto Materials:

1. Sto joint treatment
2. StoGuard® Mesh
3. StoGuard® Waterproof Air Barrier Membrane options:
  - a. StoGuard®Gold Coat® (vapor permeable)
  - b. StoGuard®EmeraldCoat® (high perm)
  - c. StoGuard®VaporSeal™ (vapor impermeable)
4. Sto DrainScreen™
5. StoQuik® Silver Finish Components:
  - a. Sto Guard Mesh
  - b. Sto Base Coat
  - c. Sto Mesh
  - d. Sto Primer (optional component)
  - e. Sto Finish

## Accessory Materials:

(including means for fastening)

1. Starter Track
2. Other accessories as may be required.  
(e.g. casing beads, control joints, etc.)

IMPORTANT: Components not identified as Sto are furnished by other manufacturers and are not necessarily installed by trades who install the Sto products. Refer to project specific contract documents.

Property of Sto Corp. All Rights Reserved.

## ATTENTION

Sto products are intended for use by qualified professional contractors, not consumers, as a component of a larger construction assembly as specified by a qualified design professional, general contractor or builder. They should be installed in accordance with those specifications and Sto's instructions. Sto Corp. disclaims all, and assumes no, liability for on-site inspections, for its products applied improperly, or by unqualified persons or entities, or as part of an improperly designed or constructed building, for the nonperformance of adjacent building components or assemblies, or for other construction activities beyond Sto's control. Improper use of Sto products or use as part of an improperly designed or constructed larger assembly or building may result in serious damage to Sto products, and to the structure of the building or its components.

STO CORP. DISCLAIMS ALL WARRANTIES EXPRESSED OR IMPLIED EXCEPT FOR EXPLICIT LIMITED WRITTEN WARRANTIES ISSUED TO AND ACCEPTED BY BUILDING OWNERS IN ACCORDANCE WITH STO'S WARRANTY PROGRAMS WHICH ARE SUBJECT TO CHANGE FROM TIME TO TIME. For the fullest, most current information on proper application, clean-up, mixing and other specifications and warranties, cautions and disclaimers, please refer to the Sto Corp. website, [www.stocorp.com](http://www.stocorp.com).

[www.stocorp.com](http://www.stocorp.com)

# StoQuik® Silver DrainScreen™ System Components - Alternative Drip Track

Detail No.: 11.02 DS

Date: January 2015

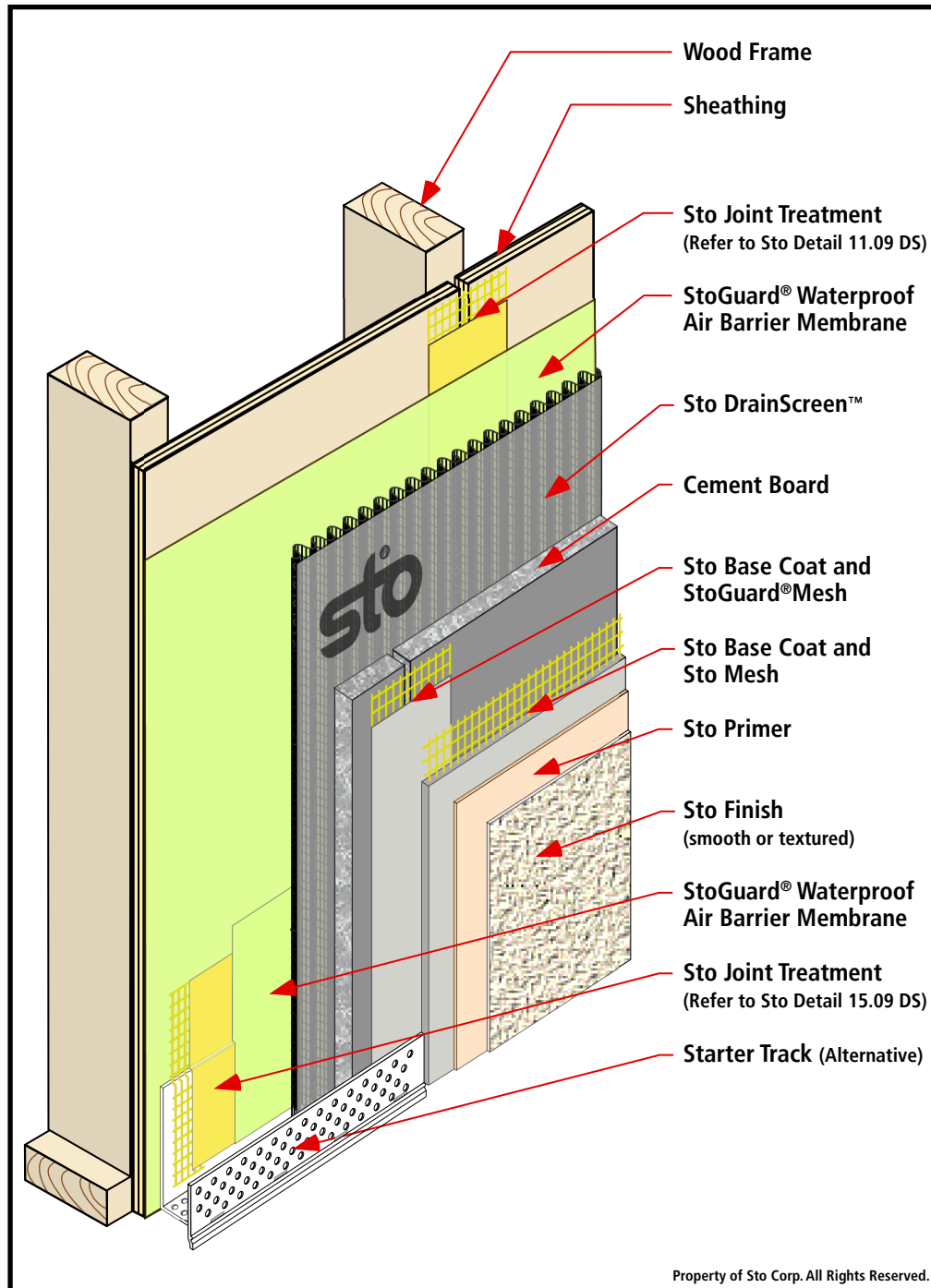

## Notes:

1. Detail shows the installation of StoQuik® Silver DrainScreen™ over a wood frame wall using an alternate drip track.
  - a. At grade along the base of the wall.
  - b. At roof line terminations. (See Sto Detail 11.62a)
  - c. At floor line terminations.
  - d. At window or door heads; in combination with flashing when window frame projects beyond finished wall surface. (See Sto Detail 11.25a.)
2. Refer to Sto Specification QS 200 DS for complete information on design requirements, installation and accessories.

IMPORTANT: Components not identified as Sto are furnished by other manufacturers and are not necessarily installed by trades who install the Sto products. Refer to project specific contract documents.

Property of Sto Corp. All Rights Reserved.

## ATTENTION

Sto products are intended for use by qualified professional contractors, not consumers, as a component of a larger construction assembly as specified by a qualified design professional, general contractor or builder. They should be installed in accordance with those specifications and Sto's instructions. Sto Corp. disclaims all, and assumes no, liability for on-site inspections, for its products applied improperly, or by unqualified persons or entities, or as part of an improperly designed or constructed building, for the nonperformance of adjacent building components or assemblies, or for other construction activities beyond Sto's control. Improper use of Sto products or use as part of an improperly designed or constructed larger assembly or building may result in serious damage to Sto products, and to the structure of the building or its components.

STO CORP. DISCLAIMS ALL WARRANTIES EXPRESSED OR IMPLIED EXCEPT FOR EXPLICIT LIMITED WRITTEN WARRANTIES ISSUED TO AND ACCEPTED BY BUILDING OWNERS IN ACCORDANCE WITH STO'S WARRANTY PROGRAMS WHICH ARE SUBJECT TO CHANGE FROM TIME TO TIME. For the fullest, most current information on proper application, clean-up, mixing and other specifications and warranties, cautions and disclaimers, please refer to the Sto Corp. website, [www.stocorp.com](http://www.stocorp.com).

[www.stocorp.com](http://www.stocorp.com)



# StoQuik® Silver DrainScreen™ "L" Bead Termination Accessory at Dissimilar Material

Detail No.: 11.03a DS

Date: January 2015

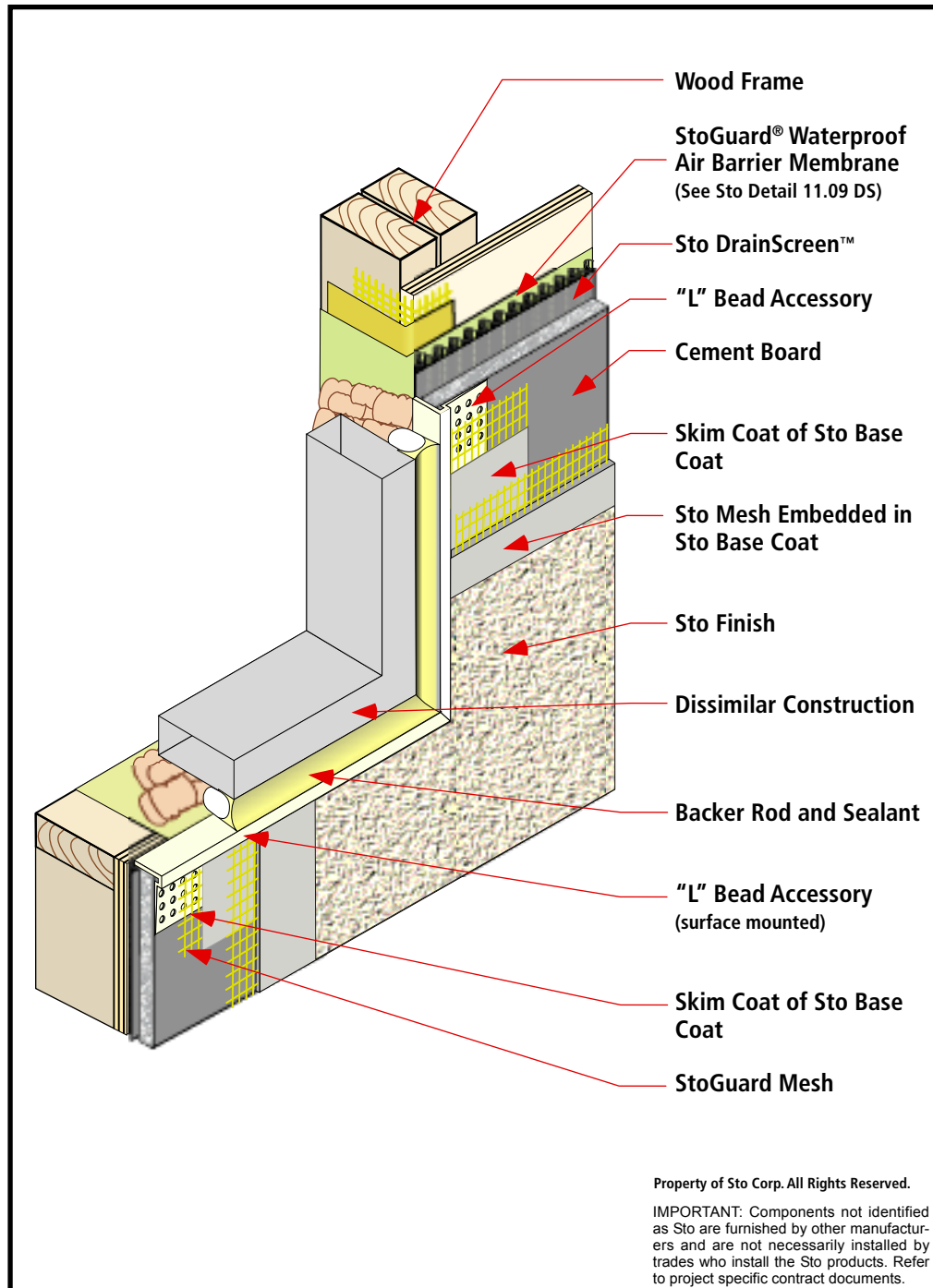

## Notes:

1. Use the "L" Bead Accessory
  - a. Terminations at windows and doors.  
(See Sto Detail 11.25a)
  - b. Terminations at dissimilar materials.  
(See Sto Detail 11.50a)
  - c. Back-to-back at expansion joints.  
(See Sto Detail 11.50a).
  - d. Window/door head in combination with flashing.  
(See Sto Detail 11.23a)
  - e. Floor line (in combination with flashing).  
(See Sto Detail 11.41a)
2. Use spray adhesive (3M Super 77 or 3M Super 90) applied to the cement board to temporarily hold the accessory in place. Place StoGuard Mesh over perforated front flange of accessory. Skim coat StoGuard Mesh with Sto base coat and allow to dry. When installing Sto Mesh, embed Sto Mesh in Sto base coat and overlap StoGuard Mesh to terminating bead of accessory.
3. Refer to Sto Specification QS 200 DS for complete information on design requirements, installation, and accessories.

## ATTENTION

Sto products are intended for use by qualified professional contractors, not consumers, as a component of a larger construction assembly as specified by a qualified design professional, general contractor or builder. They should be installed in accordance with those specifications and Sto's instructions. Sto Corp. disclaims all, and assumes no, liability for on-site inspections, for its products applied improperly, or by unqualified persons or entities, or as part of an improperly designed or constructed building, for the nonperformance of adjacent building components or assemblies, or for other construction activities beyond Sto's control. Improper use of Sto products or use as part of an improperly designed or constructed larger assembly or building may result in serious damage to Sto products, and to the structure of the building or its components.

STO CORP. DISCLAIMS ALL WARRANTIES EXPRESSED OR IMPLIED EXCEPT FOR EXPLICIT LIMITED WRITTEN WARRANTIES ISSUED TO AND ACCEPTED BY BUILDING OWNERS IN ACCORDANCE WITH STO'S WARRANTY PROGRAMS WHICH ARE SUBJECT TO CHANGE FROM TIME TO TIME. For the fullest, most current information on proper application, clean-up, mixing and other specifications and warranties, cautions and disclaimers, please refer to the Sto Corp. website, [www.stocorp.com](http://www.stocorp.com).

[www.stocorp.com](http://www.stocorp.com)

# StoQuik® Silver DrainScreen™ Casing Bead Accessory at Dissimilar Material

Detail No.: 11.03b DS

Date: January 2015

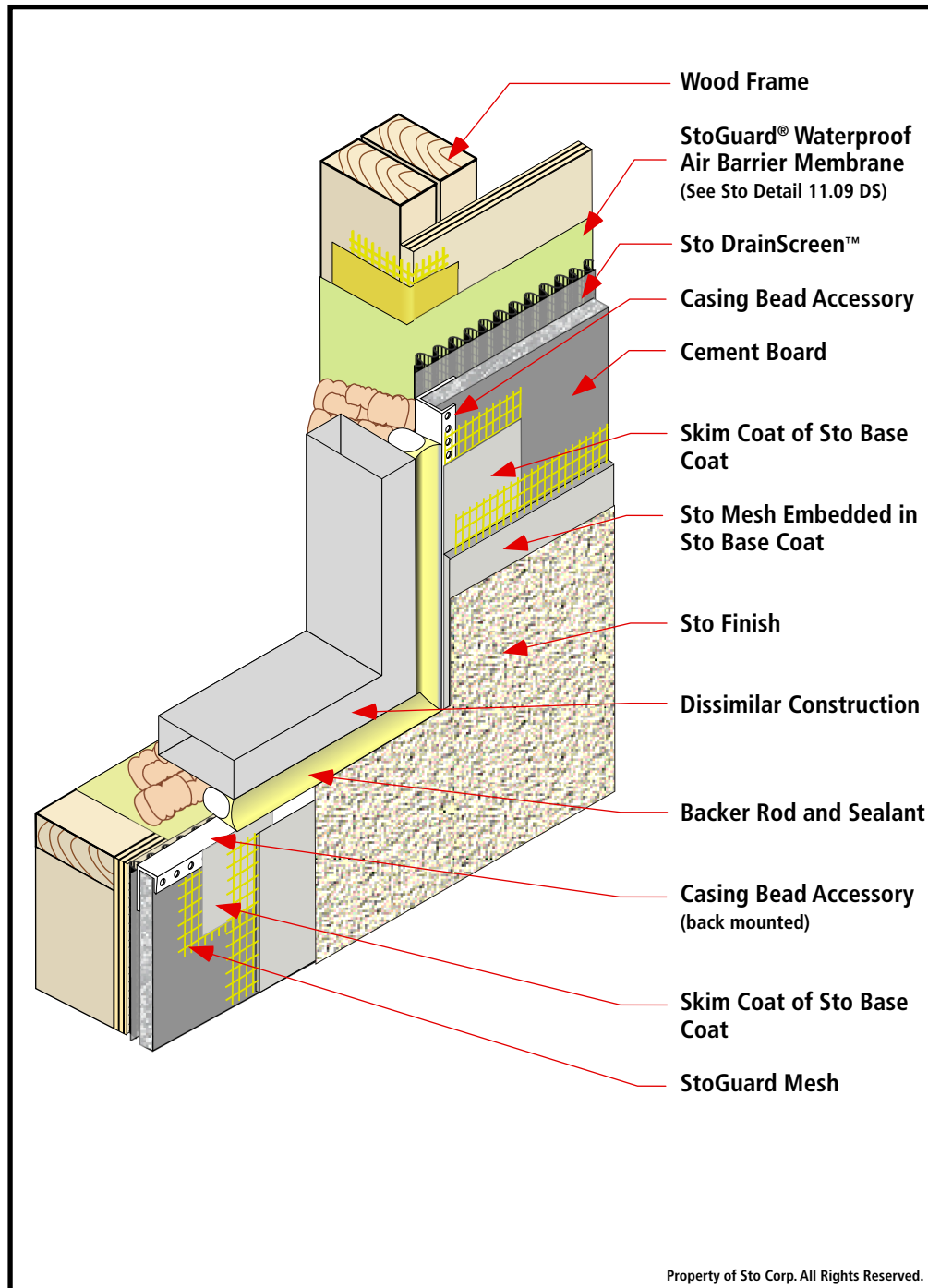

## Notes:

1. Use Casing Bead Accessory:
  - a. Terminations at windows and doors. (See Sto Detail 11.25a)
  - b. Terminations at dissimilar materials. (See Sto Detail 11.50a)
  - c. Back-to-back as expansion joints. (See Sto Detail 11.50a)
2. Place StoGuard Mesh over perforated front flange of accessory. Skim coat StoGuard Mesh with Sto base coat and allow to dry. When installing Sto Mesh, embed Sto Mesh in Sto base coat and overlap StoGuard Mesh to terminating edge of accessory.
3. Refer to Sto Specification QS 200E for complete information on design requirements, installation, and accessories.

IMPORTANT: Components not identified as Sto are furnished by other manufacturers and are not necessarily installed by trades who install the Sto products. Refer to project specific contract documents.

## ATTENTION

Sto products are intended for use by qualified professional contractors, not consumers, as a component of a larger construction assembly as specified by a qualified design professional, general contractor or builder. They should be installed in accordance with those specifications and Sto's instructions. Sto Corp. disclaims all, and assumes no, liability for on-site inspections, for its products applied improperly, or by unqualified persons or entities, or as part of an improperly designed or constructed building, for the nonperformance of adjacent building components or assemblies, or for other construction activities beyond Sto's control. Improper use of Sto products or use as part of an improperly designed or constructed larger assembly or building may result in serious damage to Sto products, and to the structure of the building or its components.

**STO CORP. DISCLAIMS ALL WARRANTIES EXPRESSED OR IMPLIED EXCEPT FOR EXPLICIT LIMITED WRITTEN WARRANTIES ISSUED TO AND ACCEPTED BY BUILDING OWNERS IN ACCORDANCE WITH STO'S WARRANTY PROGRAMS WHICH ARE SUBJECT TO CHANGE FROM TIME TO TIME.** For the fullest, most current information on proper application, clean-up, mixing and other specifications and warranties, cautions and disclaimers, please refer to the Sto Corp. website, [www.stocorp.com](http://www.stocorp.com).

[www.stocorp.com](http://www.stocorp.com)

# StoQuik® Silver DrainScreen™ Control Joint Accessory (Face Mount)

Detail No.: 11.03c DS

Date: January 2015

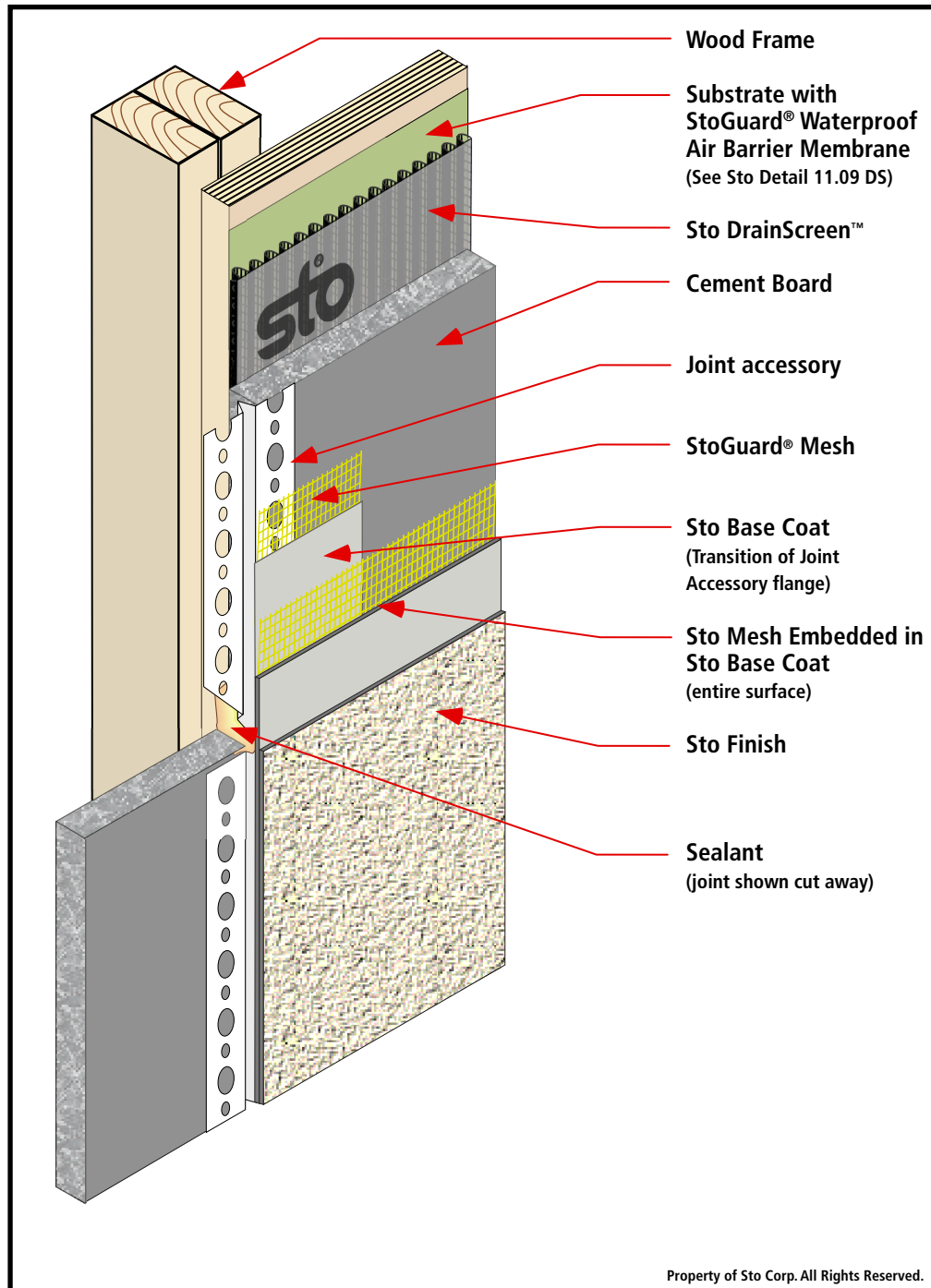

## Notes:

1. Use Control Joint Accessory in the field of the wall to accommodate thermal movement.
2. Use at intervals of 25 feet (7.6 m) maximum with light colored finishes (Lightness Value  $\geq 50$ ). Use at intervals of 16 feet (4.9 m) maximum with dark colored finishes (Lightness Value  $\leq 50$  and  $\geq 30$ ). When laying out control joints create rectangular panels of maximum 625 square feet (58 m<sup>2</sup>) with length to width ratio of 2-1/2 to 1 maximum for light colored finishes. For dark colored finishes create panels of maximum 256 square feet (23.5 m<sup>2</sup>) with length to width ratio of 2-1/2 to 1 maximum.
3. Cement board must be interrupted to accommodate control joint accessory, provide solid support for attachment of cement board: double studs, a "scab stud", or solid sheathing such as OSB or plywood.
4. Use spray adhesive (3M Super 77 or Super 90) applied to the cement board to temporarily hold the accessory in place. Place StoGuard Mesh over perforated front flange of accessory. Skim coat StoGuard Mesh with Sto base coat and allow to dry. When installing Sto Mesh, embed Sto Mesh in Sto base coat and overlap StoGuard Mesh to terminating bead of accessory.
5. Refer to Sto Specification QS 200 DS for complete information on design requirements, installation and accessories.

IMPORTANT: Components not identified as Sto are furnished by other manufacturers and are not necessarily installed by trades who install the Sto products. Refer to project specific contract documents.

## ATTENTION

Sto products are intended for use by qualified professional contractors, not consumers, as a component of a larger construction assembly as specified by a qualified design professional, general contractor or builder. They should be installed in accordance with those specifications and Sto's instructions. Sto Corp. disclaims all, and assumes no, liability for on-site inspections, for its products applied improperly, or by unqualified persons or entities, or as part of an improperly designed or constructed building, for the nonperformance of adjacent building components or assemblies, or for other construction activities beyond Sto's control. Improper use of Sto products or use as part of an improperly designed or constructed larger assembly or building may result in serious damage to Sto products, and to the structure of the building or its components.

STO CORP. DISCLAIMS ALL WARRANTIES EXPRESSED OR IMPLIED EXCEPT FOR EXPLICIT LIMITED WRITTEN WARRANTIES ISSUED TO AND ACCEPTED BY BUILDING OWNERS IN ACCORDANCE WITH STO'S WARRANTY PROGRAMS WHICH ARE SUBJECT TO CHANGE FROM TIME TO TIME. For the fullest, most current information on proper application, clean-up, mixing and other specifications and warranties, cautions and disclaimers, please refer to the Sto Corp. website, [www.stocorp.com](http://www.stocorp.com).

[www.stocorp.com](http://www.stocorp.com)

# StoQuik® Silver DrainScreen™ Control Joint Accessory (Back Mount)

Detail No.: 11.03d DS

Date: January 2015

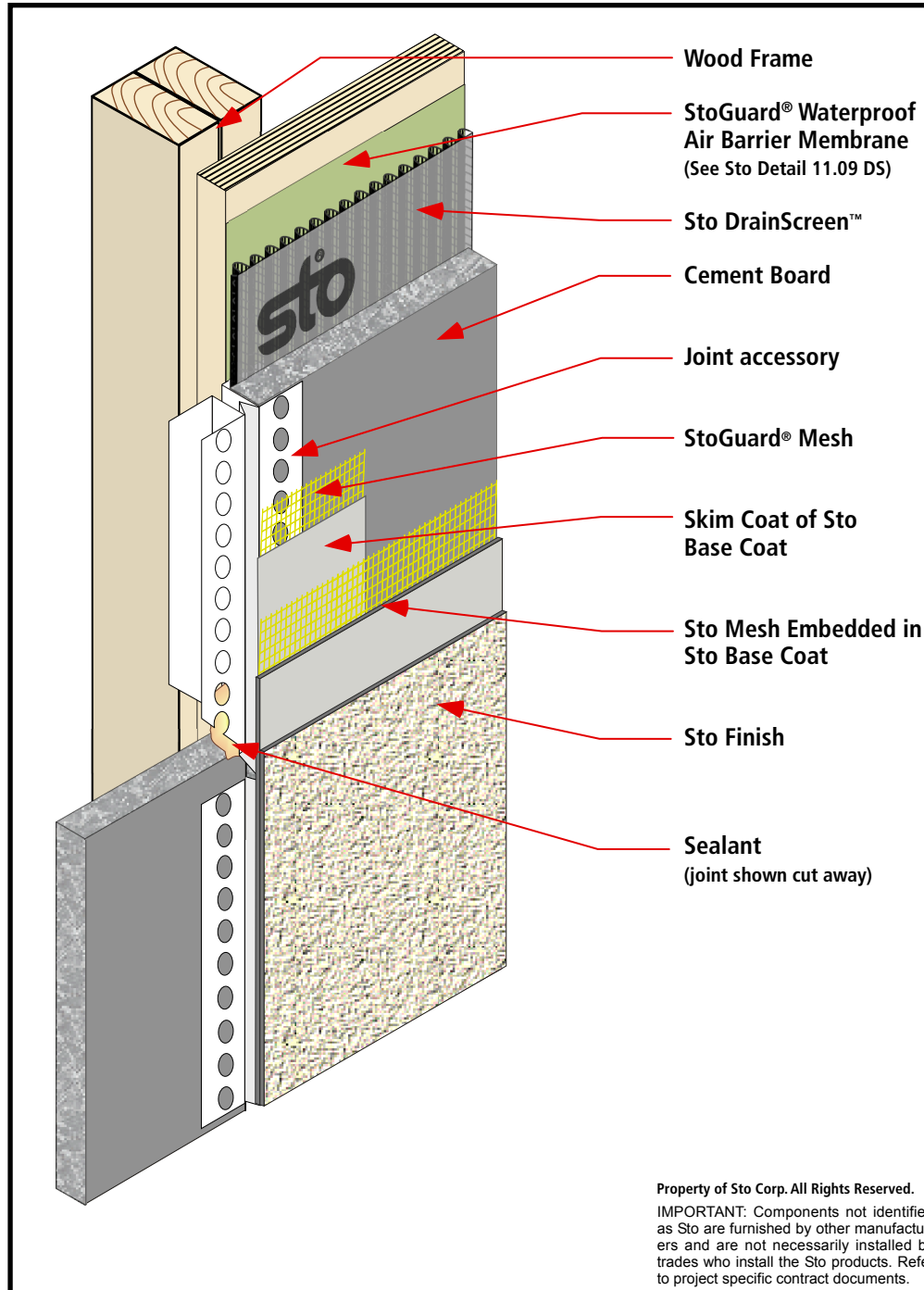

## Notes:

1. Use Control Joint Accessory in the field of the wall to accommodate thermal movement.
2. Use at intervals of 25 feet (7.6 m) maximum with light colored finishes (Lightness Value  $\geq 50$ ). Use at intervals of 16 feet (4.9 m) maximum with dark colored finishes (Lightness Value  $\leq 50$  and  $\geq 30$ ). When laying out control joints create rectangular panels of maximum 625 square feet (58 m<sup>2</sup>) with length to width ratio of 2-1/2 to 1 maximum for light colored finishes. For dark colored finishes create panels of maximum 256 square feet (23.5 m<sup>2</sup>) with length to width ratio of 2-1/2 to 1 maximum.
3. Cement board must be interrupted to accommodate control joint accessory, provide solid support for attachment of cement board: double studs, a "scab stud", or solid sheathing such as OSB or plywood.
4. Accessory may be back mounted with fasteners or friction fit into installed cement board on one side, followed by insertion of adjacent cement board on the other side.
5. Place StoGuard Mesh over perforated front flange of accessory. Skim coat StoGuard Mesh with Sto base coat and allow to dry. When installing Sto Mesh, embed Sto Mesh in Sto base coat and overlap StoGuard Mesh to terminating bead of accessory.
6. Refer to Sto Specification QS 200 DS for complete information on design requirements, installation and accessories.

## ATTENTION

Sto products are intended for use by qualified professional contractors, not consumers, as a component of a larger construction assembly as specified by a qualified design professional, general contractor or builder. They should be installed in accordance with those specifications and Sto's instructions. Sto Corp. disclaims all, and assumes no, liability for on-site inspections, for its products applied improperly, or by unqualified persons or entities, or as part of an improperly designed or constructed building, for the nonperformance of adjacent building components or assemblies, or for other construction activities beyond Sto's control. Improper use of Sto products or use as part of an improperly designed or constructed larger assembly or building may result in serious damage to Sto products, and to the structure of the building or its components.

STO CORP. DISCLAIMS ALL WARRANTIES EXPRESSED OR IMPLIED EXCEPT FOR EXPLICIT LIMITED WRITTEN WARRANTIES ISSUED TO AND ACCEPTED BY BUILDING OWNERS IN ACCORDANCE WITH STO'S WARRANTY PROGRAMS WHICH ARE SUBJECT TO CHANGE FROM TIME TO TIME. For the fullest, most current information on proper application, clean-up, mixing and other specifications and warranties, cautions and disclaimers, please refer to the Sto Corp. website, [www.stocorp.com](http://www.stocorp.com).

[www.stocorp.com](http://www.stocorp.com)

# StoQuik® Silver DrainScreen™ Foam Aesthetic Band /Projection (Thick)

Detail No.: 11.04a DS

Date: January 2015

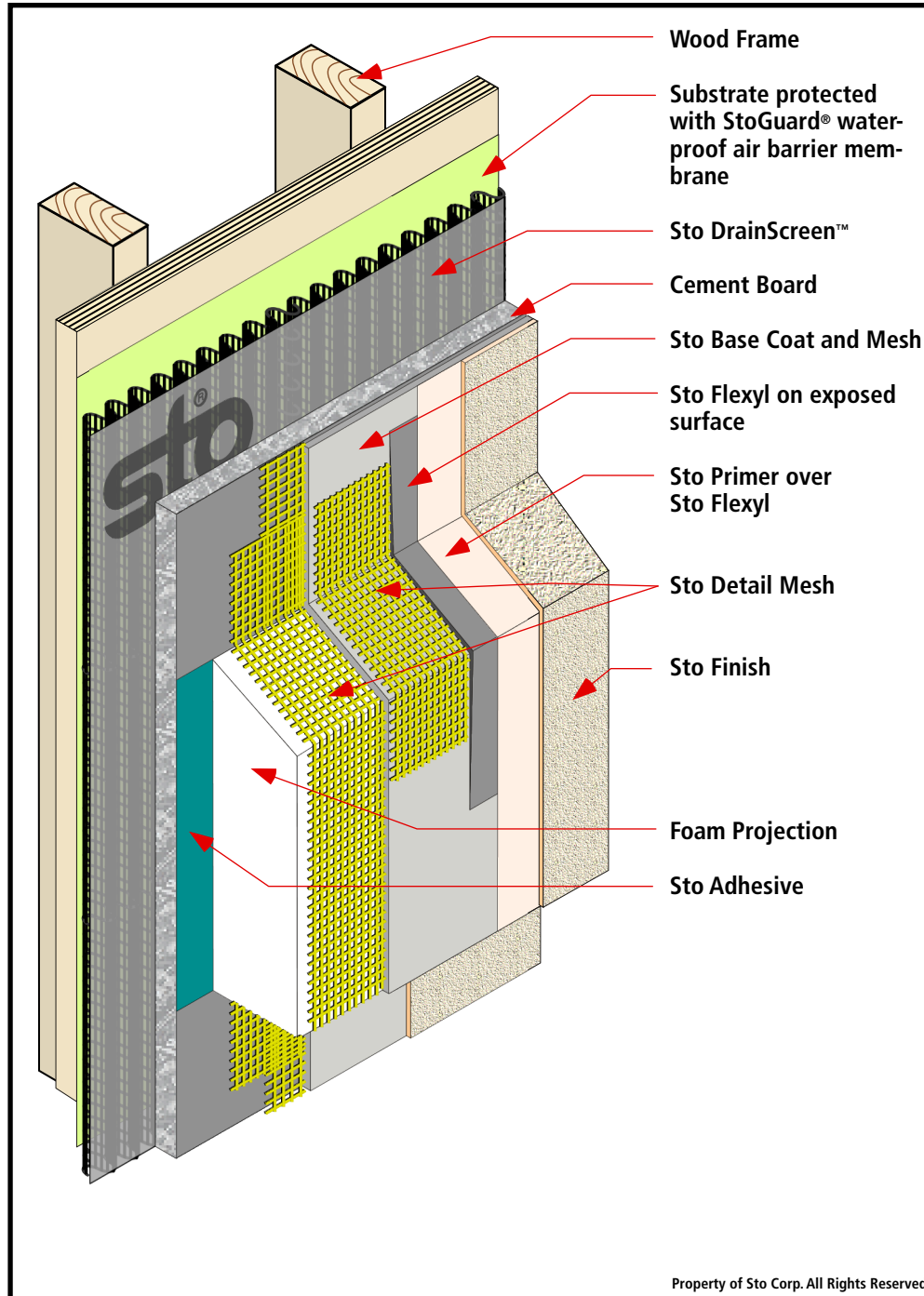

## Notes:

1. The maximum thickness of Extruded Polystyrene (EPS) allowed by code is typically 4" (100mm).
2. The exposed surface must have a minimum slope of 1:2 (27). In locations where ice and snow may accumulate, increase slope.
3. See Sto detail 11.04b DS where the projection is less than 2" (50mm) or where snow and ice are not likely to accumulate.
4. Refer to Sto Specification QS 200 DS for complete information on design requirements, installation and accessories.

IMPORTANT: Components not identified as Sto are furnished by other manufacturers and are not necessarily installed by trades who install the Sto products. Refer to project specific contract documents.

## ATTENTION

Sto products are intended for use by qualified professional contractors, not consumers, as a component of a larger construction assembly as specified by a qualified design professional, general contractor or builder. They should be installed in accordance with those specifications and Sto's instructions. Sto Corp. disclaims all, and assumes no, liability for on-site inspections, for its products applied improperly, or by unqualified persons or entities, or as part of an improperly designed or constructed building, for the nonperformance of adjacent building components or assemblies, or for other construction activities beyond Sto's control. Improper use of Sto products or use as part of an improperly designed or constructed larger assembly or building may result in serious damage to Sto products, and to the structure of the building or its components.

STO CORP. DISCLAIMS ALL WARRANTIES EXPRESSED OR IMPLIED EXCEPT FOR EXPLICIT LIMITED WRITTEN WARRANTIES ISSUED TO AND ACCEPTED BY BUILDING OWNERS IN ACCORDANCE WITH STO'S WARRANTY PROGRAMS WHICH ARE SUBJECT TO CHANGE FROM TIME TO TIME. For the fullest, most current information on proper application, clean-up, mixing and other specifications and warranties, cautions and disclaimers, please refer to the Sto Corp. website, [www.stocorp.com](http://www.stocorp.com).

[www.stocorp.com](http://www.stocorp.com)



# StoQuik® Silver DrainScreen™ Foam Aesthetic Band /Projection (Thin)

Detail No.: 11.04b DS

Date: January 2015

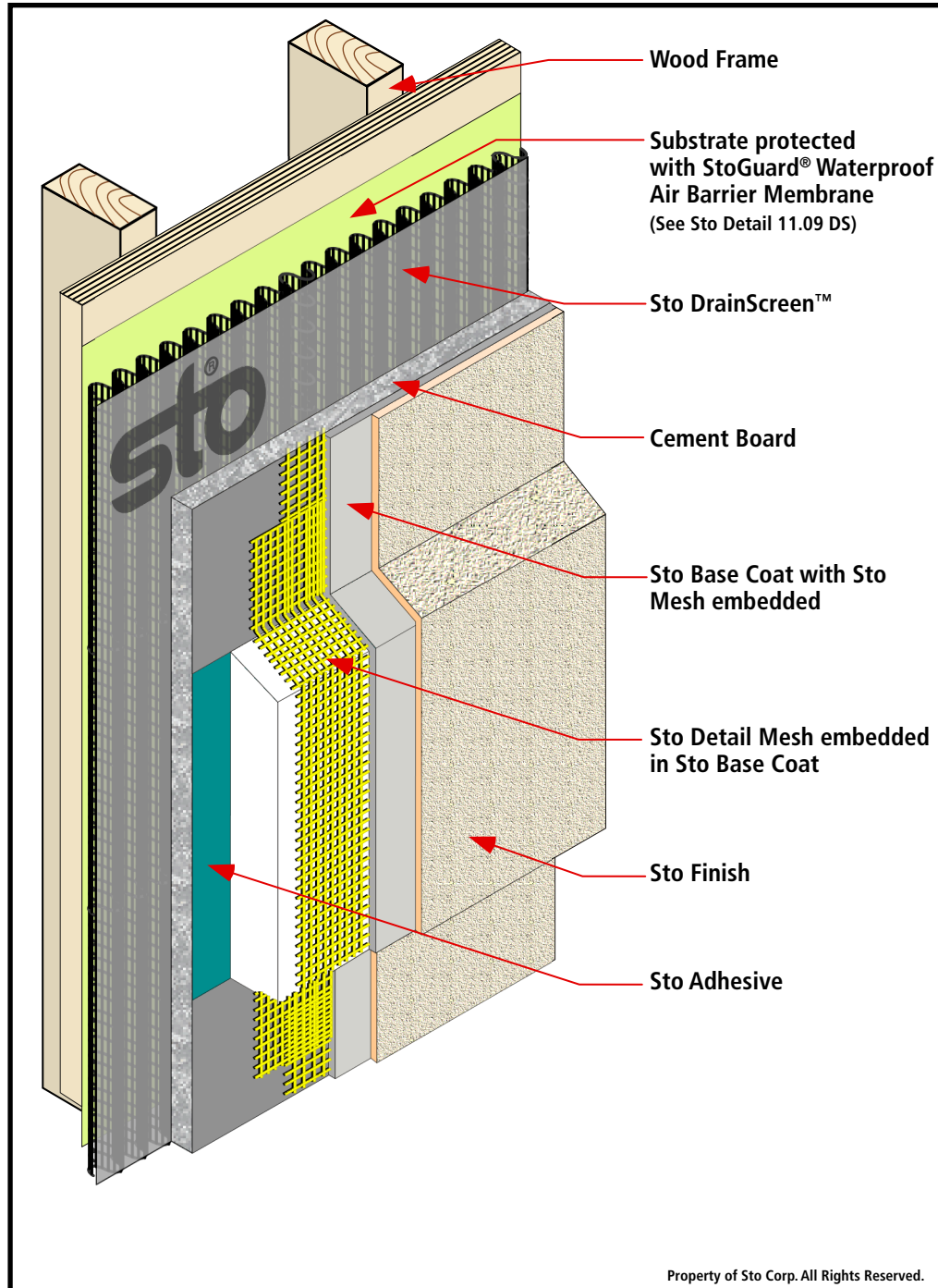

## Notes:

1. The maximum thickness of foam plastic insulation allowed by code is typically 4" (100mm).
2. The exposed surface must have a minimum slope of 1:2 (27). In locations where ice and snow may accumulate, increase slope.
3. See Sto detail 11.04a DS where the projection is more than 2" (50mm) or where snow and ice are likely to accumulate.
4. Refer to Sto Specification QS 200 DS for complete information on design requirements, installation and accessories.

IMPORTANT: Components not identified as Sto are furnished by other manufacturers and are not necessarily installed by trades who install the Sto products. Refer to project specific contract documents.

## ATTENTION

Sto products are intended for use by qualified professional contractors, not consumers, as a component of a larger construction assembly as specified by a qualified design professional, general contractor or builder. They should be installed in accordance with those specifications and Sto's instructions. Sto Corp. disclaims all, and assumes no, liability for on-site inspections, for its products applied improperly, or by unqualified persons or entities, or as part of an improperly designed or constructed building, for the nonperformance of adjacent building components or assemblies, or for other construction activities beyond Sto's control. Improper use of Sto products or use as part of an improperly designed or constructed larger assembly or building may result in serious damage to Sto products, and to the structure of the building or its components.

STO CORP. DISCLAIMS ALL WARRANTIES EXPRESSED OR IMPLIED EXCEPT FOR EXPLICIT LIMITED WRITTEN WARRANTIES ISSUED TO AND ACCEPTED BY BUILDING OWNERS IN ACCORDANCE WITH STO'S WARRANTY PROGRAMS WHICH ARE SUBJECT TO CHANGE FROM TIME TO TIME. For the fullest, most current information on proper application, clean-up, mixing and other specifications and warranties, cautions and disclaimers, please refer to the Sto Corp. website, [www.stocorp.com](http://www.stocorp.com).

[www.stocorp.com](http://www.stocorp.com)

# StoQuik® Silver DrainScreen™ Termination at Sidewalk over Wood Frame

Detail No.: 11.11 DS

Date: January 2015

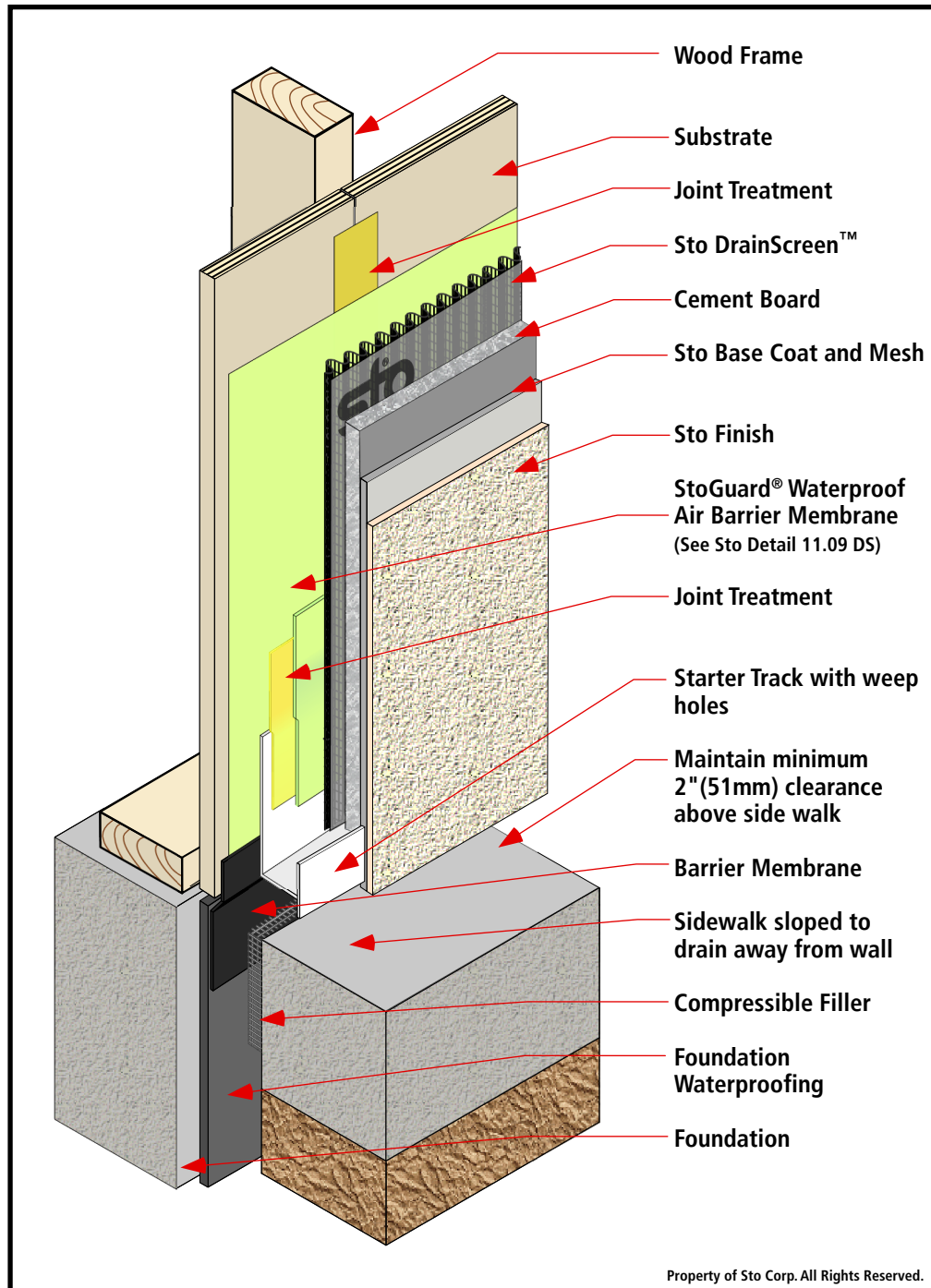
**Notes:**

1. Provide a positive slope of sidewalk away from the wall.
2. Protect wall assembly from rising damp.
3. Provide minimum 2" (50mm) clearance above pavers or other finished walking surfaces, minimum 4" (100mm) above earth grade. Increase distance above grade for snow regions.
4. Refer to Sto Specification QS 200 DS for complete information on design requirements, installation and accessories.

IMPORTANT: Components not identified as Sto are furnished by other manufacturers and are not necessarily installed by trades who install the Sto products. Refer to project specific contract documents.

**ATTENTION**

Sto products are intended for use by qualified professional contractors, not consumers, as a component of a larger construction assembly as specified by a qualified design professional, general contractor or builder. They should be installed in accordance with those specifications and Sto's instructions. Sto Corp. disclaims all, and assumes no, liability for on-site inspections, for its products applied improperly, or by unqualified persons or entities, or as part of an improperly designed or constructed building, for the nonperformance of adjacent building components or assemblies, or for other construction activities beyond Sto's control. Improper use of Sto products or use as part of an improperly designed or constructed larger assembly or building may result in serious damage to Sto products, and to the structure of the building or its components.

STO CORP. DISCLAIMS ALL WARRANTIES EXPRESSED OR IMPLIED EXCEPT FOR EXPLICIT LIMITED WRITTEN WARRANTIES ISSUED TO AND ACCEPTED BY BUILDING OWNERS IN ACCORDANCE WITH STO'S WARRANTY PROGRAMS WHICH ARE SUBJECT TO CHANGE FROM TIME TO TIME. For the fullest, most current information on proper application, clean-up, mixing and other specifications and warranties, cautions and disclaimers, please refer to the Sto Corp. website, [www.stocorp.com](http://www.stocorp.com).

[www.stocorp.com](http://www.stocorp.com)

# StoQuik® Silver DrainScreen™ Rough Opening Protection over Wood Frame

Detail No.: 11.20a DS

Date: January 2015

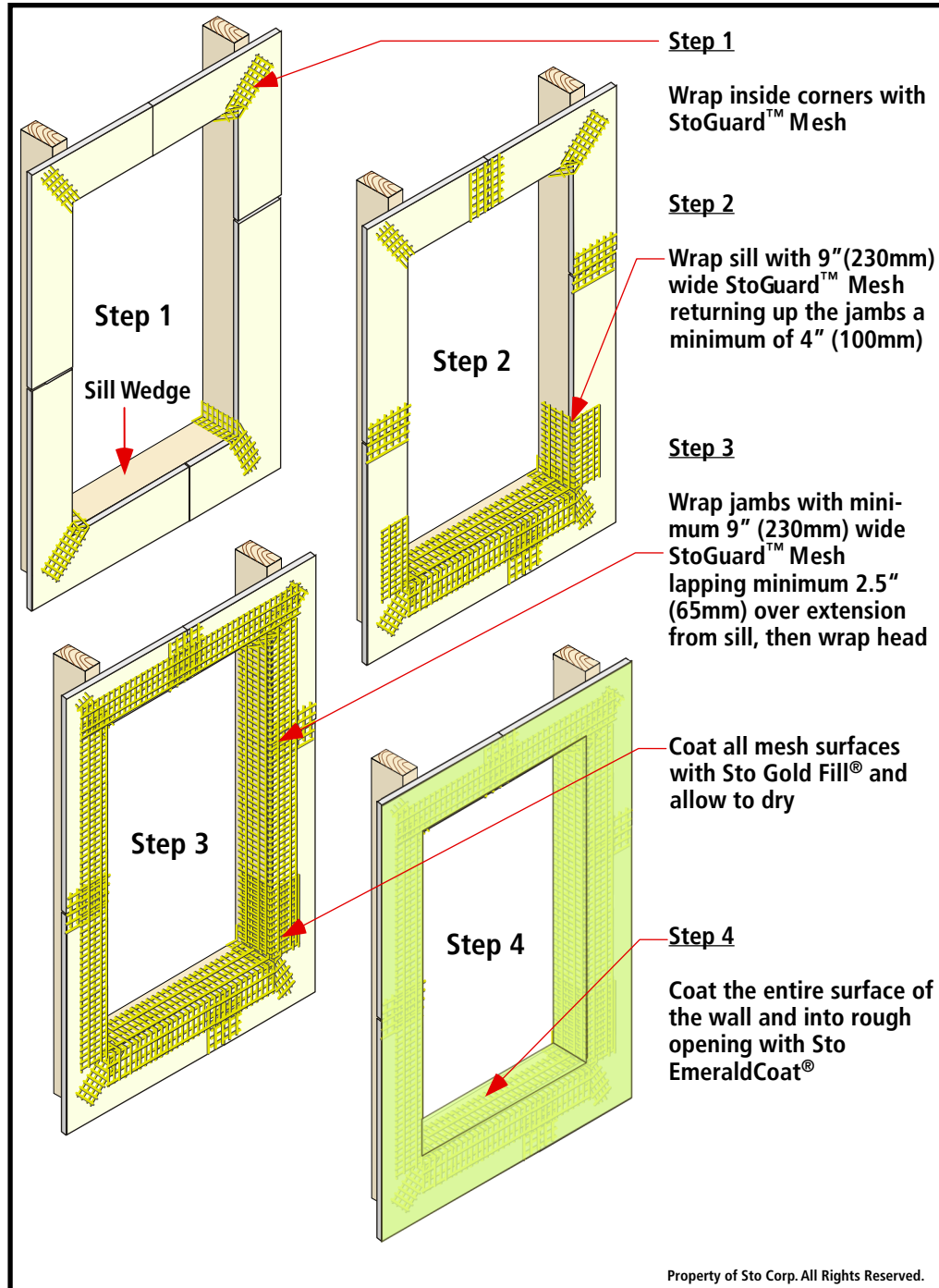
**Notes:**

1. Prepare opening prior to the installation of the window or mechanical equipment.
2. Incorporate flashing as illustrated in 11.25a DS - 11.26a DS.
3. The complete installation of window or mechanical equipment should include an air seal between the object and the StoGuard™ protection inbound of the outer sealant joint.
4. Refer to Sto Specification QS 200 DS for complete information on design requirements, installation and accessories.

IMPORTANT: Components not identified as Sto are furnished by other manufacturers and are not necessarily installed by trades who install the Sto products. Refer to project specific contract documents.

**ATTENTION**

Sto products are intended for use by qualified professional contractors, not consumers, as a component of a larger construction assembly as specified by a qualified design professional, general contractor or builder. They should be installed in accordance with those specifications and Sto's instructions. Sto Corp. disclaims all, and assumes no, liability for on-site inspections, for its products applied improperly, or by unqualified persons or entities, or as part of an improperly designed or constructed building, for the nonperformance of adjacent building components or assemblies, or for other construction activities beyond Sto's control. Improper use of Sto products or use as part of an improperly designed or constructed larger assembly or building may result in serious damage to Sto products, and to the structure of the building or its components.

STO CORP. DISCLAIMS ALL WARRANTIES EXPRESSED OR IMPLIED EXCEPT FOR EXPLICIT LIMITED WRITTEN WARRANTIES ISSUED TO AND ACCEPTED BY BUILDING OWNERS IN ACCORDANCE WITH STO'S WARRANTY PROGRAMS WHICH ARE SUBJECT TO CHANGE FROM TIME TO TIME. For the fullest, most current information on proper application, clean-up, mixing and other specifications and warranties, cautions and disclaimers, please refer to the Sto Corp. website, [www.stocorp.com](http://www.stocorp.com).

[www.stocorp.com](http://www.stocorp.com)



# StoQuik® Silver DrainScreen™ Brick Mold Window Head

Detail No.: 11.20b DS

Date: January 2015

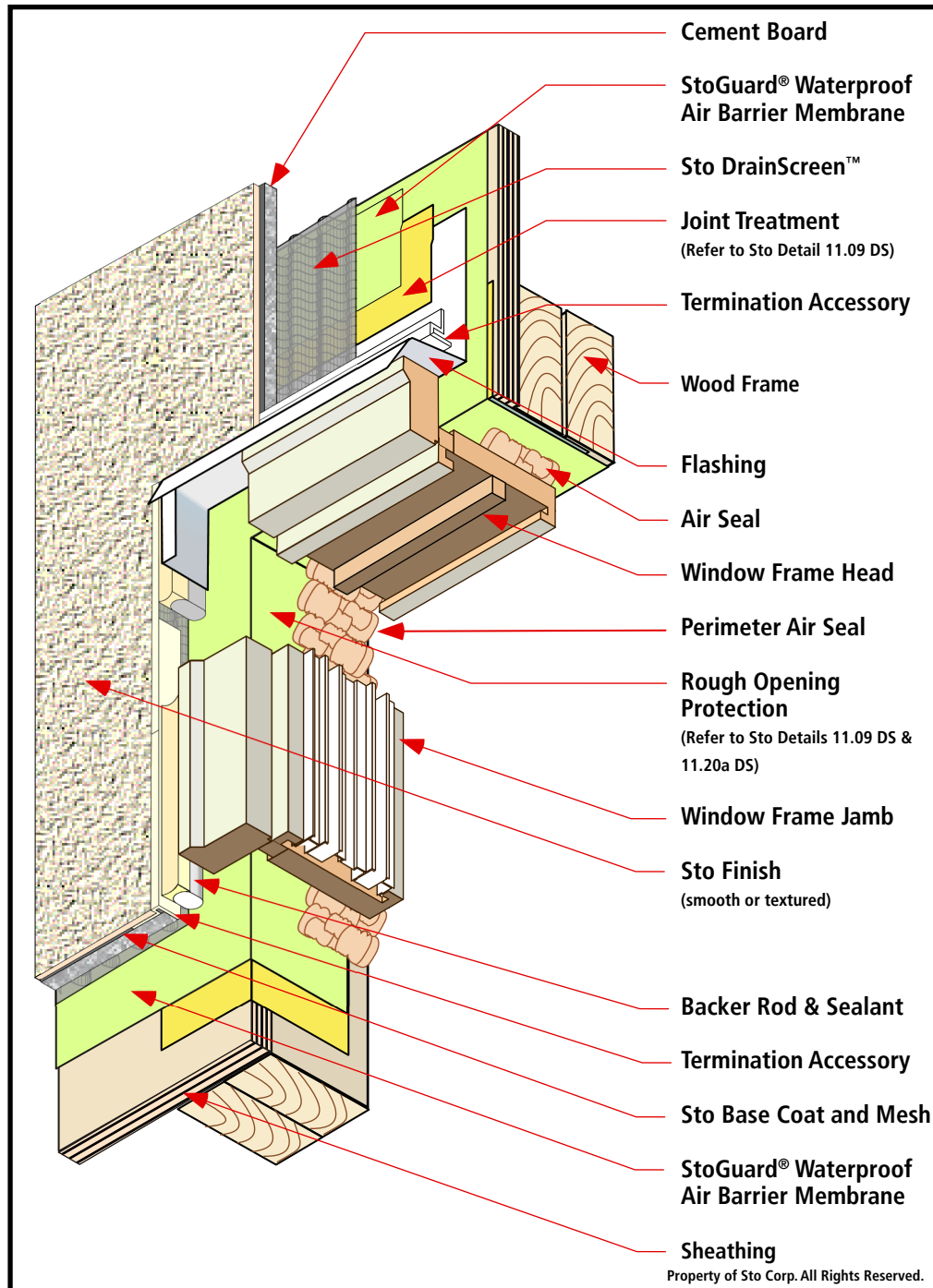

## Notes:

1. Protect the rough opening from water penetration by wrapping with StoGuard® (See Sto Details: 11.09 DS and 11.20a DS)
2. Provide head flashing over the window to direct water away from the window. Fold flashing over the window head-jamb interface or provide head flashing end dams, depending on window type and design.
3. Provide continuous air barrier around the interior perimeter of the window to reduce leaking, condensation related to air movement, sound and insect intrusion.
4. Refer to Sto Specification QS 200DS for complete information on design requirements, installation and accessories.

IMPORTANT: Components not identified as Sto are furnished by other manufacturers and are not necessarily installed by trades who install the Sto products. Refer to project specific contract documents.

## ATTENTION

Sto products are intended for use by qualified professional contractors, not consumers, as a component of a larger construction assembly as specified by a qualified design professional, general contractor or builder. They should be installed in accordance with those specifications and Sto's instructions. Sto Corp. disclaims all, and assumes no, liability for on-site inspections, for its products applied improperly, or by unqualified persons or entities, or as part of an improperly designed or constructed building, for the nonperformance of adjacent building components or assemblies, or for other construction activities beyond Sto's control. Improper use of Sto products or use as part of an improperly designed or constructed larger assembly or building may result in serious damage to Sto products, and to the structure of the building or its components.

STO CORP. DISCLAIMS ALL WARRANTIES EXPRESSED OR IMPLIED EXCEPT FOR EXPLICIT LIMITED WRITTEN WARRANTIES ISSUED TO AND ACCEPTED BY BUILDING OWNERS IN ACCORDANCE WITH STO'S WARRANTY PROGRAMS WHICH ARE SUBJECT TO CHANGE FROM TIME TO TIME. For the fullest, most current information on proper application, clean-up, mixing and other specifications and warranties, cautions and disclaimers, please refer to the Sto Corp. website, [www.stocorp.com](http://www.stocorp.com).

[www.stocorp.com](http://www.stocorp.com)

Property of Sto Corp. All Rights Reserved.

# StoQuik® Silver DrainScreen™ Brick Mold Window Sill / Jamb

Detail No.: 11.20c DS

Date: January 2015

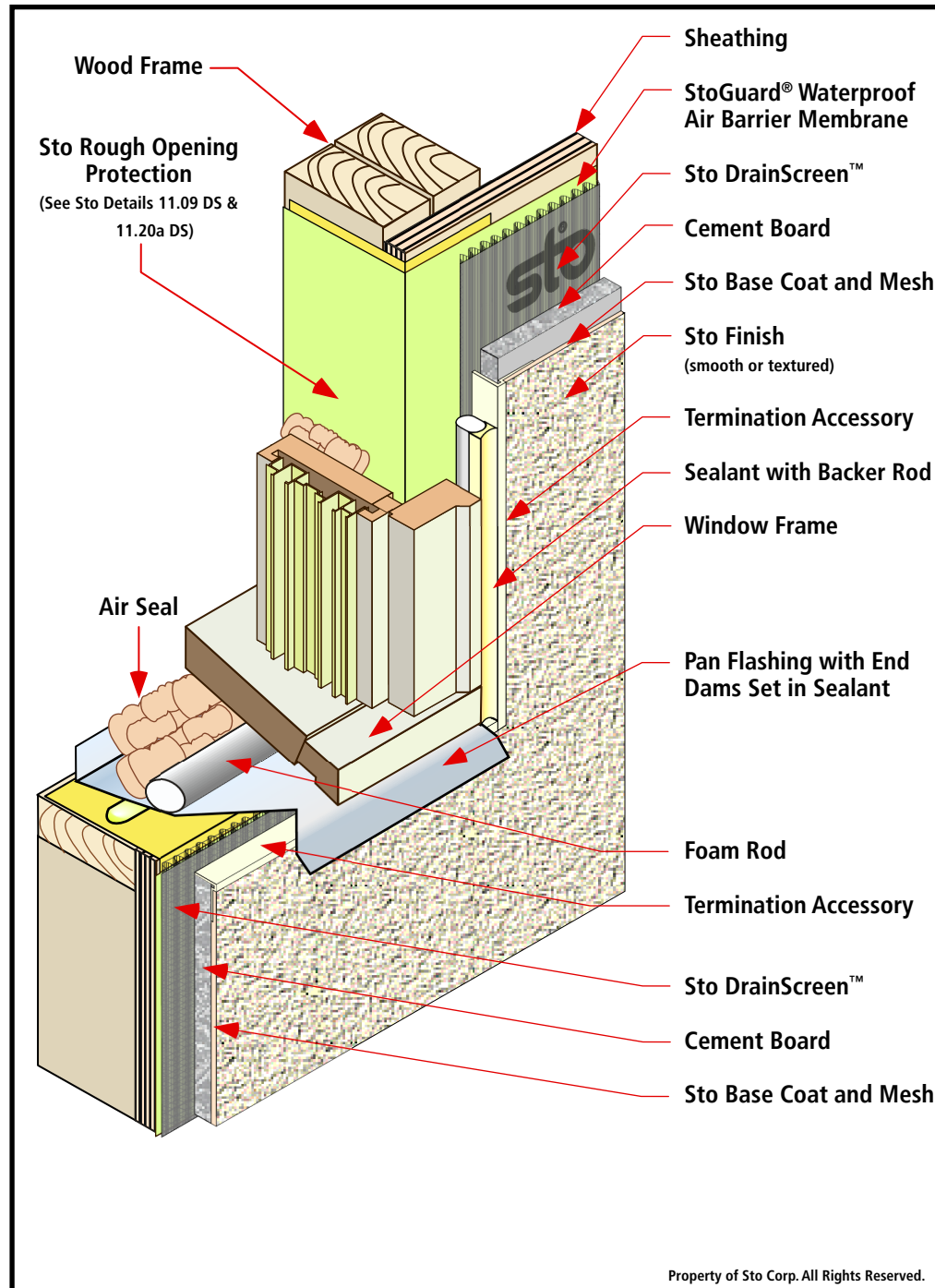

## Notes:

1. Protect the rough opening from water penetration by wrapping with Sto Joint Treatment.  
(See Sto Details 11.09 DS & 11.20a DS).
2. Direct any water penetration to the exterior at the sill pan flashing.
3. Lap the Sto joint treatment into the sill pan.  
(See Sto Detail 11.21a DS)
4. Provide a continuous air barrier around the interior perimeter of the window to reduce leaking, condensation related to air movement, and sound and insect control.
5. Refer to Sto Specification QS 200DS for complete information on design requirements, installation and accessories.

IMPORTANT: Components not identified as Sto are furnished by other manufacturers and are not necessarily installed by trades who install the Sto products. Refer to project specific contract documents.

## ATTENTION

Sto products are intended for use by qualified professional contractors, not consumers, as a component of a larger construction assembly as specified by a qualified design professional, general contractor or builder. They should be installed in accordance with those specifications and Sto's instructions. Sto Corp. disclaims all, and assumes no, liability for on-site inspections, for its products applied improperly, or by unqualified persons or entities, or as part of an improperly designed or constructed building, for the nonperformance of adjacent building components or assemblies, or for other construction activities beyond Sto's control. Improper use of Sto products or use as part of an improperly designed or constructed larger assembly or building may result in serious damage to Sto products, and to the structure of the building or its components.

STO CORP. DISCLAIMS ALL WARRANTIES EXPRESSED OR IMPLIED EXCEPT FOR EXPLICIT LIMITED WRITTEN WARRANTIES ISSUED TO AND ACCEPTED BY BUILDING OWNERS IN ACCORDANCE WITH STO'S WARRANTY PROGRAMS WHICH ARE SUBJECT TO CHANGE FROM TIME TO TIME. For the fullest, most current information on proper application, clean-up, mixing and other specifications and warranties, cautions and disclaimers, please refer to the Sto Corp. website, [www.stocorp.com](http://www.stocorp.com).

[www.stocorp.com](http://www.stocorp.com)

# StoQuik® Silver DrainScreen™ Pan Flashing at Opening Sill

**Detail No.: 11.21a DS**

**Date: January 2015**

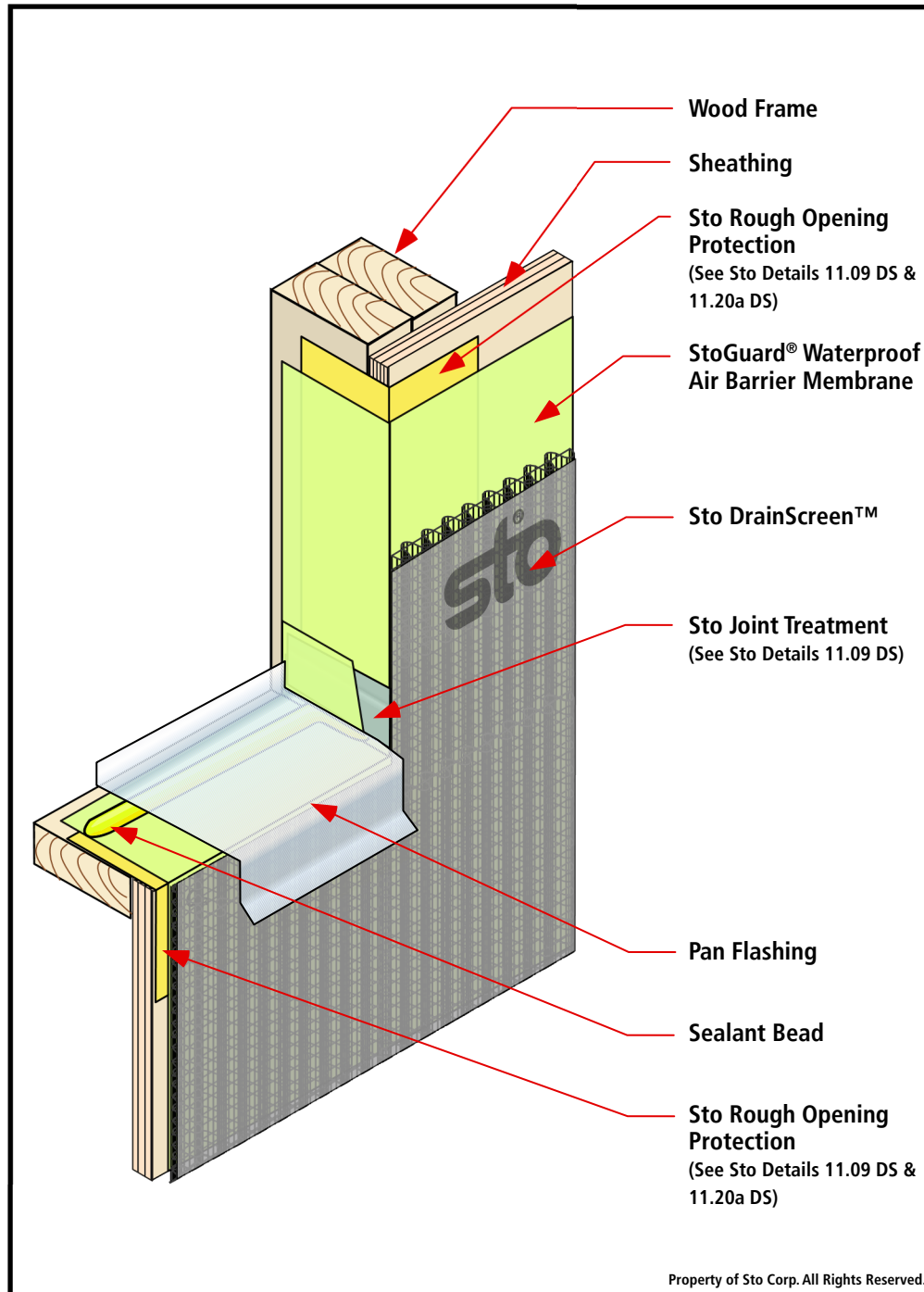

Property of Sto Corp. All Rights Reserved.

## Notes:

1. Wrap opening as shown in Sto Detail 11.20a DS
2. Install one or more beads of neutral-cure, silicone sealant on the sill and jamb.
3. Install the sill pan flashing into the wet sealant and press it into place. Tool any excess sealant off at the top of the side dams and back edge of the pan flashing.
4. When installed the seal between the pan flashing and the rough opening protection must be air-tight.
5. Lap Sto Joint Treatment onto the end dams so water draining down the jamb will be directed into the pan flashing and out of the wall assembly.
6. Refer to Sto Specification QS 200 DS for complete information on design requirements, installation and accessories.

IMPORTANT: Components not identified as Sto are furnished by other manufacturers and are not necessarily installed by trades who install the Sto products. Refer to project specific contract documents.

## ATTENTION

Sto products are intended for use by qualified professional contractors, not consumers, as a component of a larger construction assembly as specified by a qualified design professional, general contractor or builder. They should be installed in accordance with those specifications and Sto's instructions. Sto Corp. disclaims all, and assumes no, liability for on-site inspections, for its products applied improperly, or by unqualified persons or entities, or as part of an improperly designed or constructed building, for the nonperformance of adjacent building components or assemblies, or for other construction activities beyond Sto's control. Improper use of Sto products or use as part of an improperly designed or constructed larger assembly or building may result in serious damage to Sto products, and to the structure of the building or its components.

STO CORP. DISCLAIMS ALL WARRANTIES EXPRESSED OR IMPLIED EXCEPT FOR EXPLICIT LIMITED WRITTEN WARRANTIES ISSUED TO AND ACCEPTED BY BUILDING OWNERS IN ACCORDANCE WITH STO'S WARRANTY PROGRAMS WHICH ARE SUBJECT TO CHANGE FROM TIME TO TIME. For the fullest, most current information on proper application, clean-up, mixing and other specifications and warranties, cautions and disclaimers, please refer to the Sto Corp. website, [www.stocorp.com](http://www.stocorp.com).

[www.stocorp.com](http://www.stocorp.com)

# StoQuik® Silver DrainScreen™ Sill Flashing: Nail-fin Window

Detail No.:11.21b DS

Date: January 2015

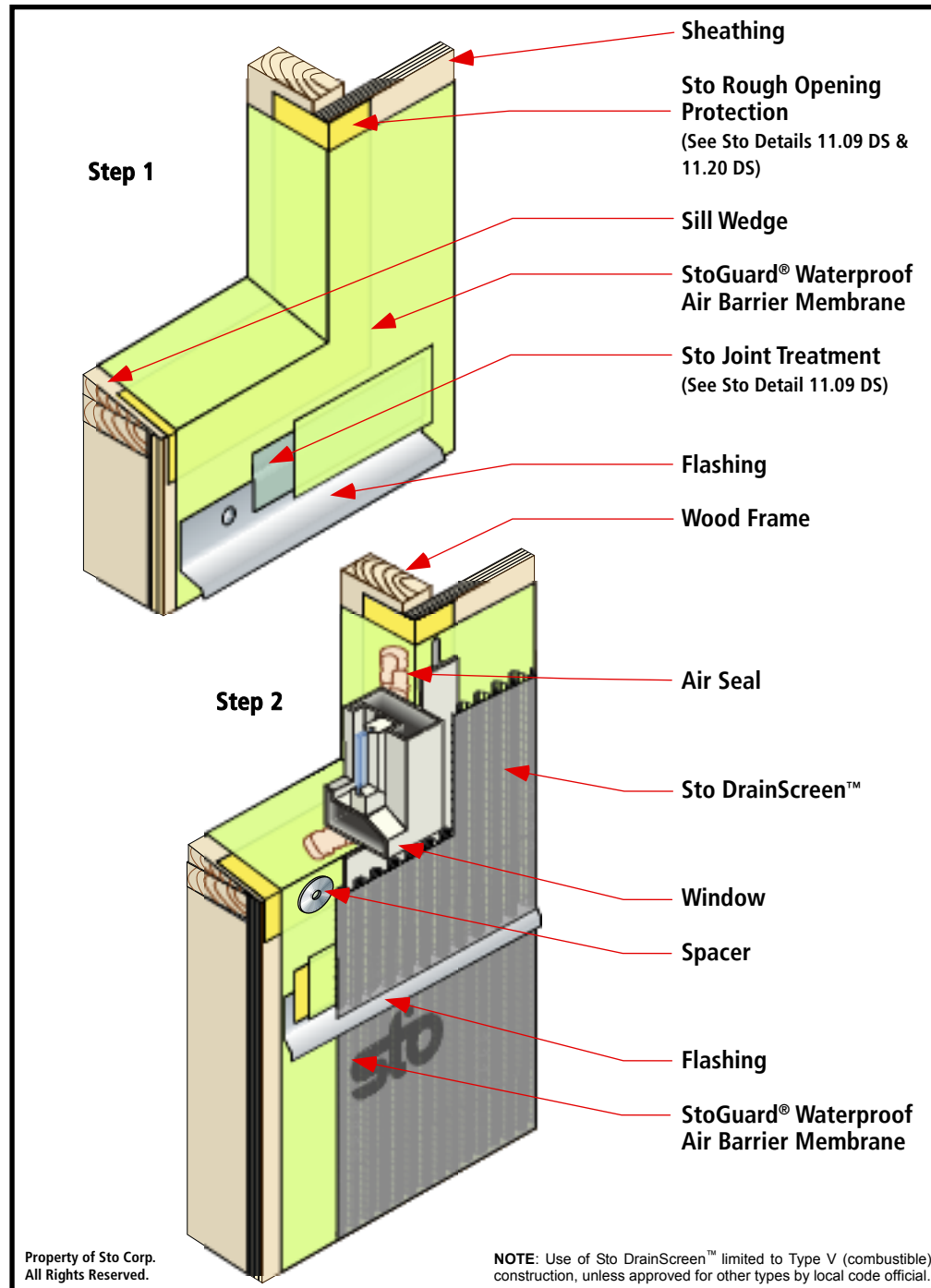

## Notes:

1. Prepare rough opening.  
(See Sto Detail 11.20 DS)
2. Install flashing below the rough opening.
3. Prepare the flashing with Sto Joint Treatment.
4. Install the nail-fin window with an air seal around the interior perimeter of the window and with spacers at the sill to create a gap for water to drain between the sill flange and the StoGuard® Waterproof Air Barrier Membrane
5. Refer to Sto Specification QS 200 DS for complete information on design requirements, installation and accessories.

IMPORTANT: Components not identified as Sto are furnished by other manufacturers and are not necessarily installed by trades who install the Sto products. Refer to project specific contract documents.

## ATTENTION

Sto products are intended for use by qualified professional contractors, not consumers, as a component of a larger construction assembly as specified by a qualified design professional, general contractor or builder. They should be installed in accordance with those specifications and Sto's instructions. Sto Corp. disclaims all, and assumes no, liability for on-site inspections, for its products applied improperly, or by unqualified persons or entities, or as part of an improperly designed or constructed building, for the nonperformance of adjacent building components or assemblies, or for other construction activities beyond Sto's control. Improper use of Sto products or use as part of an improperly designed or constructed larger assembly or building may result in serious damage to Sto products, and to the structure of the building or its components.

STO CORP. DISCLAIMS ALL WARRANTIES EXPRESSED OR IMPLIED EXCEPT FOR EXPLICIT LIMITED WRITTEN WARRANTIES ISSUED TO AND ACCEPTED BY BUILDING OWNERS IN ACCORDANCE WITH STO'S WARRANTY PROGRAMS WHICH ARE SUBJECT TO CHANGE FROM TIME TO TIME. For the fullest, most current information on proper application, clean-up, mixing and other specifications and warranties, cautions and disclaimers, please refer to the Sto Corp. website, [www.stocorp.com](http://www.stocorp.com).

[www.stocorp.com](http://www.stocorp.com)

# StoQuik® Silver DrainScreen™ Deck Flashing

Detail No.: 11.32 DS

Date: January 2015

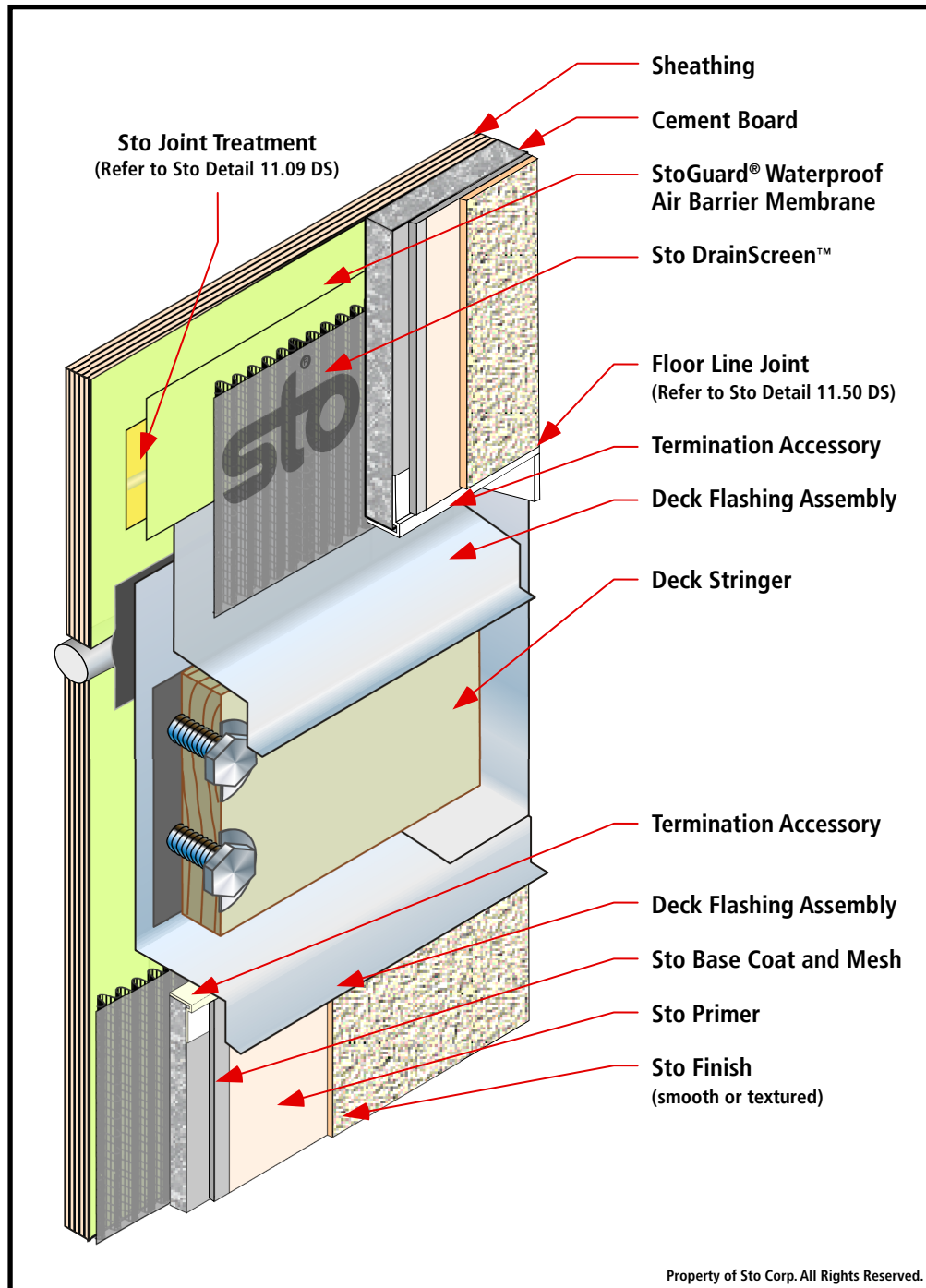

## Notes:

1. Install StoGuard® Waterproof Air Barrier Membrane on the sheathing per plans and specifications.
2. Install deck flashing to divert water away from penetrations and to drain water to the exterior of the finished cladding.
3. Provide backer rod and sealant between the deck flashing assembly and the termination accessories installed around the vertical sides of the deck.
4. Refer to Sto Specification QS 200 DS for complete information on design requirements, installation and accessories.

IMPORTANT: Components not identified as Sto are furnished by other manufacturers and are not necessarily installed by trades who install the Sto products. Refer to project specific contract documents.

Property of Sto Corp. All Rights Reserved.

## ATTENTION

Sto products are intended for use by qualified professional contractors, not consumers, as a component of a larger construction assembly as specified by a qualified design professional, general contractor or builder. They should be installed in accordance with those specifications and Sto's instructions. Sto Corp. disclaims all, and assumes no, liability for on-site inspections, for its products applied improperly, or by unqualified persons or entities, or as part of an improperly designed or constructed building, for the nonperformance of adjacent building components or assemblies, or for other construction activities beyond Sto's control. Improper use of Sto products or use as part of an improperly designed or constructed larger assembly or building may result in serious damage to Sto products, and to the structure of the building or its components.

STO CORP. DISCLAIMS ALL WARRANTIES EXPRESSED OR IMPLIED EXCEPT FOR EXPLICIT LIMITED WRITTEN WARRANTIES ISSUED TO AND ACCEPTED BY BUILDING OWNERS IN ACCORDANCE WITH STO'S WARRANTY PROGRAMS WHICH ARE SUBJECT TO CHANGE FROM TIME TO TIME. For the fullest, most current information on proper application, clean-up, mixing and other specifications and warranties, cautions and disclaimers, please refer to the Sto Corp. website, [www.stocorp.com](http://www.stocorp.com).

[www.stocorp.com](http://www.stocorp.com)



# StoQuik<sup>®</sup> Silver DrainScreen<sup>™</sup> Termination at Soffit

Detail No.: 11.40 DS

Date: January 2015

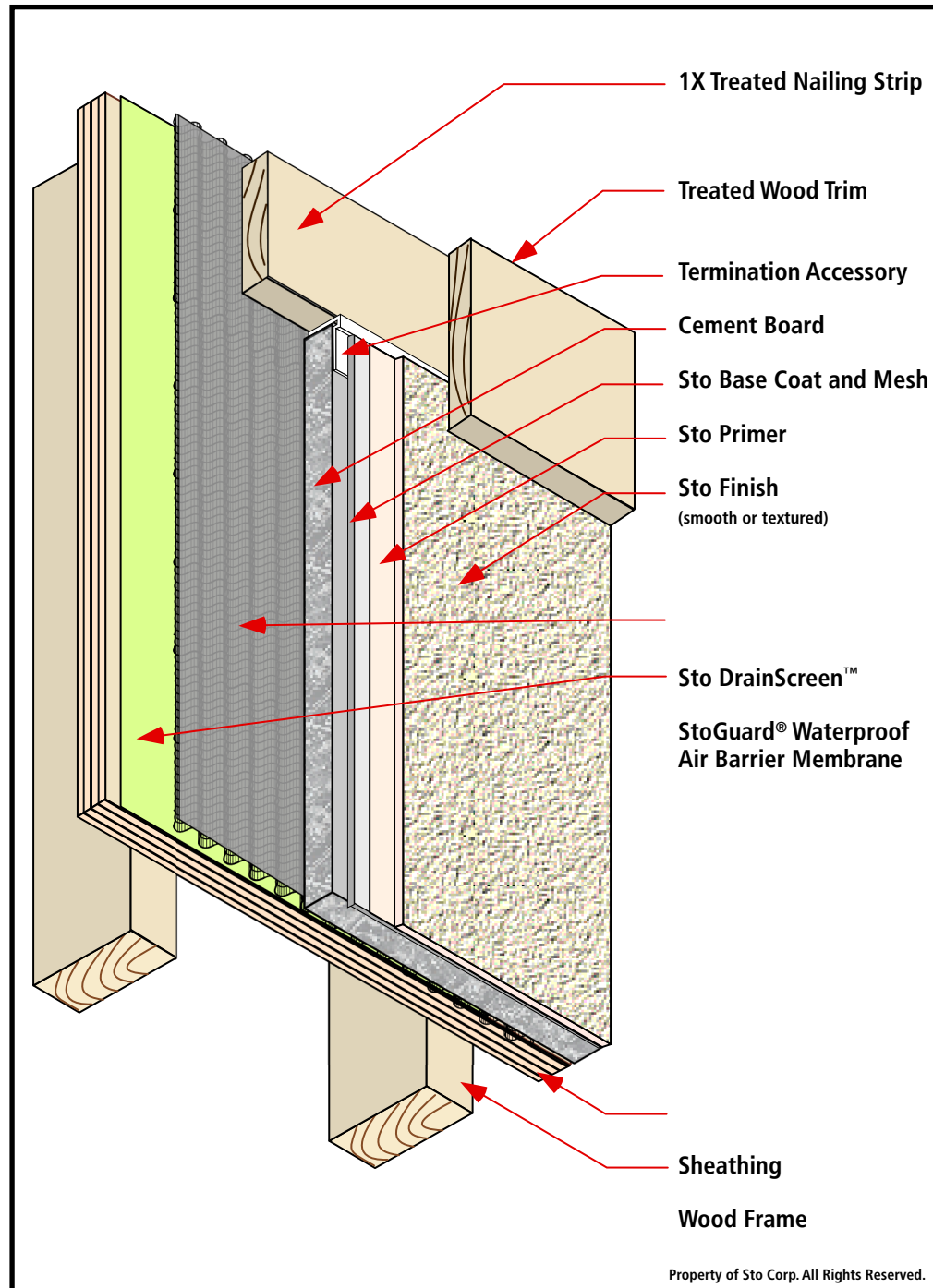

## Notes:

1. Install StoGuard<sup>®</sup> Waterproof Air Barrier Membrane on the sheathing per plans and specifications.
2. StoGuard<sup>®</sup> is a component in the air barrier assembly for a building. The design professional or builder must provide connections to other air barriers to make the entire envelope air-tight. This detail assumes that the air barrier connection would be made prior to the installation of the 1x treated nailing strip.
3. Refer to Sto Specification QS 200 DS for complete information on design requirements, installation and accessories.

IMPORTANT: Components not identified as Sto are furnished by other manufacturers and are not necessarily installed by trades who install the Sto products. Refer to project specific contract documents.

## ATTENTION

Sto products are intended for use by qualified professional contractors, not consumers, as a component of a larger construction assembly as specified by a qualified design professional, general contractor or builder. They should be installed in accordance with those specifications and Sto's instructions. Sto Corp. disclaims all, and assumes no, liability for on-site inspections, for its products applied improperly, or by unqualified persons or entities, or as part of an improperly designed or constructed building, for the nonperformance of adjacent building components or assemblies, or for other construction activities beyond Sto's control. Improper use of Sto products or use as part of an improperly designed or constructed larger assembly or building may result in serious damage to Sto products, and to the structure of the building or its components.

STO CORP. DISCLAIMS ALL WARRANTIES EXPRESSED OR IMPLIED EXCEPT FOR EXPLICIT LIMITED WRITTEN WARRANTIES ISSUED TO AND ACCEPTED BY BUILDING OWNERS IN ACCORDANCE WITH STO'S WARRANTY PROGRAMS WHICH ARE SUBJECT TO CHANGE FROM TIME TO TIME. For the fullest, most current information on proper application, clean-up, mixing and other specifications and warranties, cautions and disclaimers, please refer to the Sto Corp. website, [www.stocorp.com](http://www.stocorp.com).

[www.stocorp.com](http://www.stocorp.com)

# StoQuik® Silver DrainScreen™ Floor Expansion Joint

Detail No.: 11.50 DS

Date: June 2011

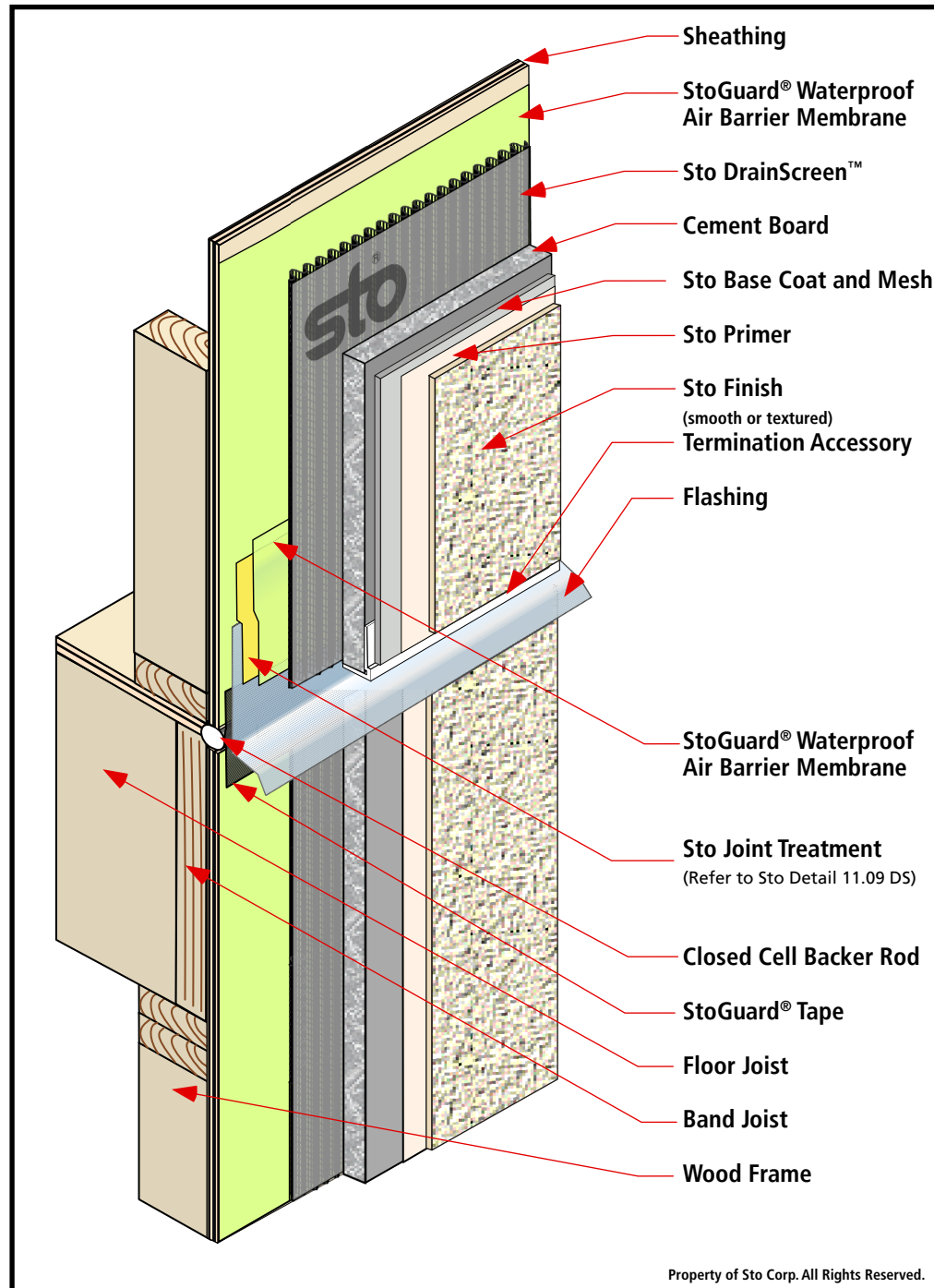

## Notes:

1. Install closed-cell backer rod into sheathing joint to support barrier membrane.
2. Install StoGuard® Tape so that it laps over StoGuard® below. Clamp the top edge of StoGuard® Tape with the flashing and shingle lap StoGuard® joint treatment over the vertical flashing leg.
3. Refer to Sto Specification QS 200 DS for complete information on design requirements, installation and accessories.

IMPORTANT: Components not identified as Sto are furnished by other manufacturers and are not necessarily installed by trades who install the Sto products. Refer to project specific contract documents.

## ATTENTION

Sto products are intended for use by qualified professional contractors, not consumers, as a component of a larger construction assembly as specified by a qualified design professional, general contractor or builder. They should be installed in accordance with those specifications and Sto's instructions. Sto Corp. disclaims all, and assumes no, liability for on-site inspections, for its products applied improperly, or by unqualified persons or entities, or as part of an improperly designed or constructed building, for the nonperformance of adjacent building components or assemblies, or for other construction activities beyond Sto's control. Improper use of Sto products or use as part of an improperly designed or constructed larger assembly or building may result in serious damage to Sto products, and to the structure of the building or its components.

**STO CORP. DISCLAIMS ALL WARRANTIES EXPRESSED OR IMPLIED EXCEPT FOR EXPLICIT LIMITED WRITTEN WARRANTIES ISSUED TO AND ACCEPTED BY BUILDING OWNERS IN ACCORDANCE WITH STO'S WARRANTY PROGRAMS WHICH ARE SUBJECT TO CHANGE FROM TIME TO TIME.** For the fullest, most current information on proper application, clean-up, mixing and other specifications and warranties, cautions and disclaimers, please refer to the Sto Corp. website, [www.stocorp.com](http://www.stocorp.com).

[www.stocorp.com](http://www.stocorp.com)

# StoQuik® Silver DrainScreen™

## Joint at Inside Corner: Different Substrates

Detail No.: 11.53a DS

Date: January 2015

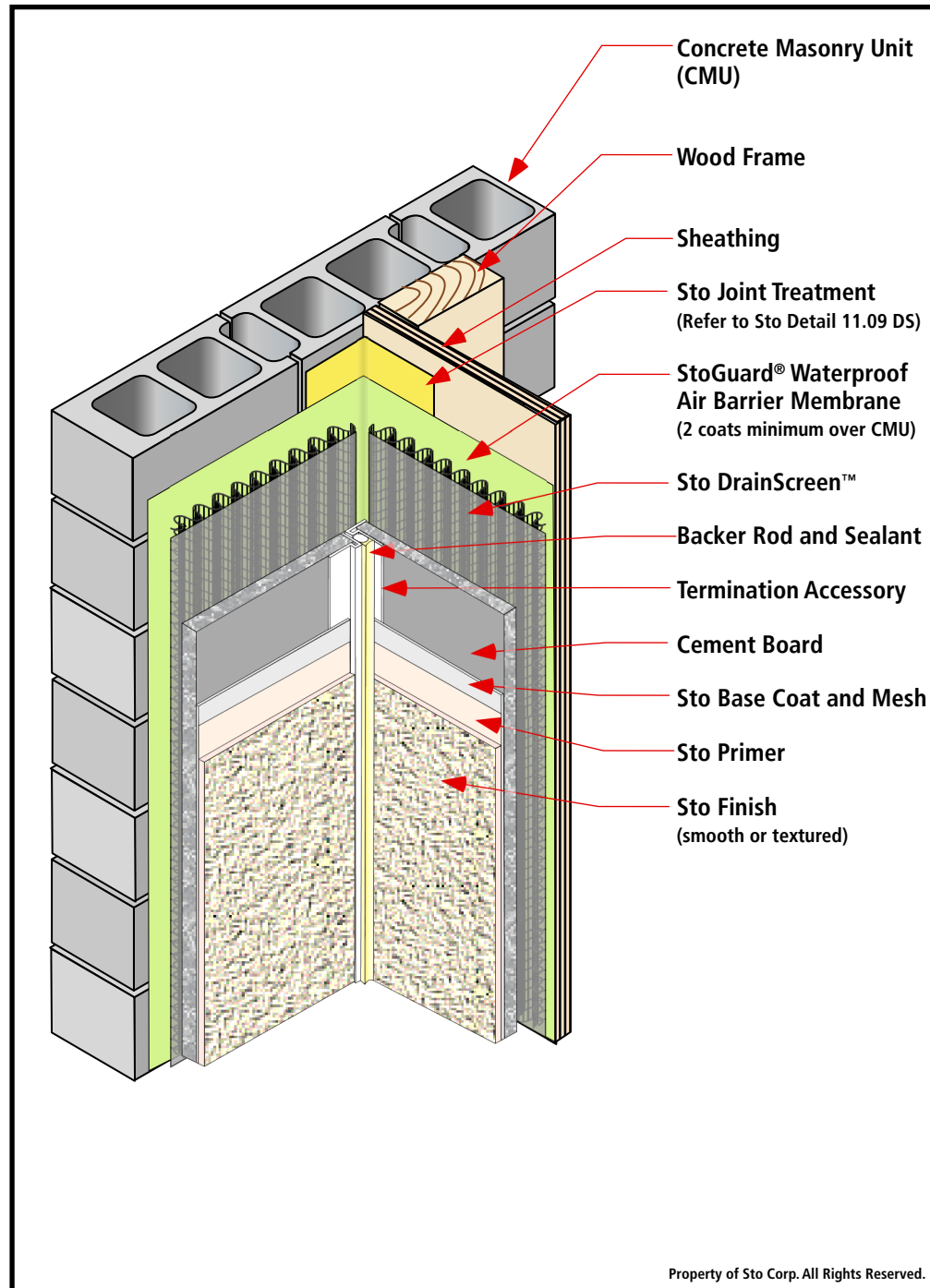
**Notes:**

1. Wrap Sto joint treatment approximately 4" (200 mm) in each direction around the inside corner.
2. Inside corner joint accessories are not required where the substrate construction is the same around the corner.
3. Refer to Sto Specification QS 200 DS for complete information on design requirements, installation and accessories.

IMPORTANT: Components not identified as Sto are furnished by other manufacturers and are not necessarily installed by trades who install the Sto products. Refer to project specific contract documents.

**ATTENTION**

Sto products are intended for use by qualified professional contractors, not consumers, as a component of a larger construction assembly as specified by a qualified design professional, general contractor or builder. They should be installed in accordance with those specifications and Sto's instructions. Sto Corp. disclaims all, and assumes no, liability for on-site inspections, for its products applied improperly, or by unqualified persons or entities, or as part of an improperly designed or constructed building, for the nonperformance of adjacent building components or assemblies, or for other construction activities beyond Sto's control. Improper use of Sto products or use as part of an improperly designed or constructed larger assembly or building may result in serious damage to Sto products, and to the structure of the building or its components.

STO CORP. DISCLAIMS ALL WARRANTIES EXPRESSED OR IMPLIED EXCEPT FOR EXPLICIT LIMITED WRITTEN WARRANTIES ISSUED TO AND ACCEPTED BY BUILDING OWNERS IN ACCORDANCE WITH STO'S WARRANTY PROGRAMS WHICH ARE SUBJECT TO CHANGE FROM TIME TO TIME. For the fullest, most current information on proper application, clean-up, mixing and other specifications and warranties, cautions and disclaimers, please refer to the Sto Corp. website, [www.stocorp.com](http://www.stocorp.com).

[www.stocorp.com](http://www.stocorp.com)



# StoQuik® Silver DrainScreen™ Joint at Inside Corner: Common Substrate

Detail No.: 11.53b DS

Date: January 2015

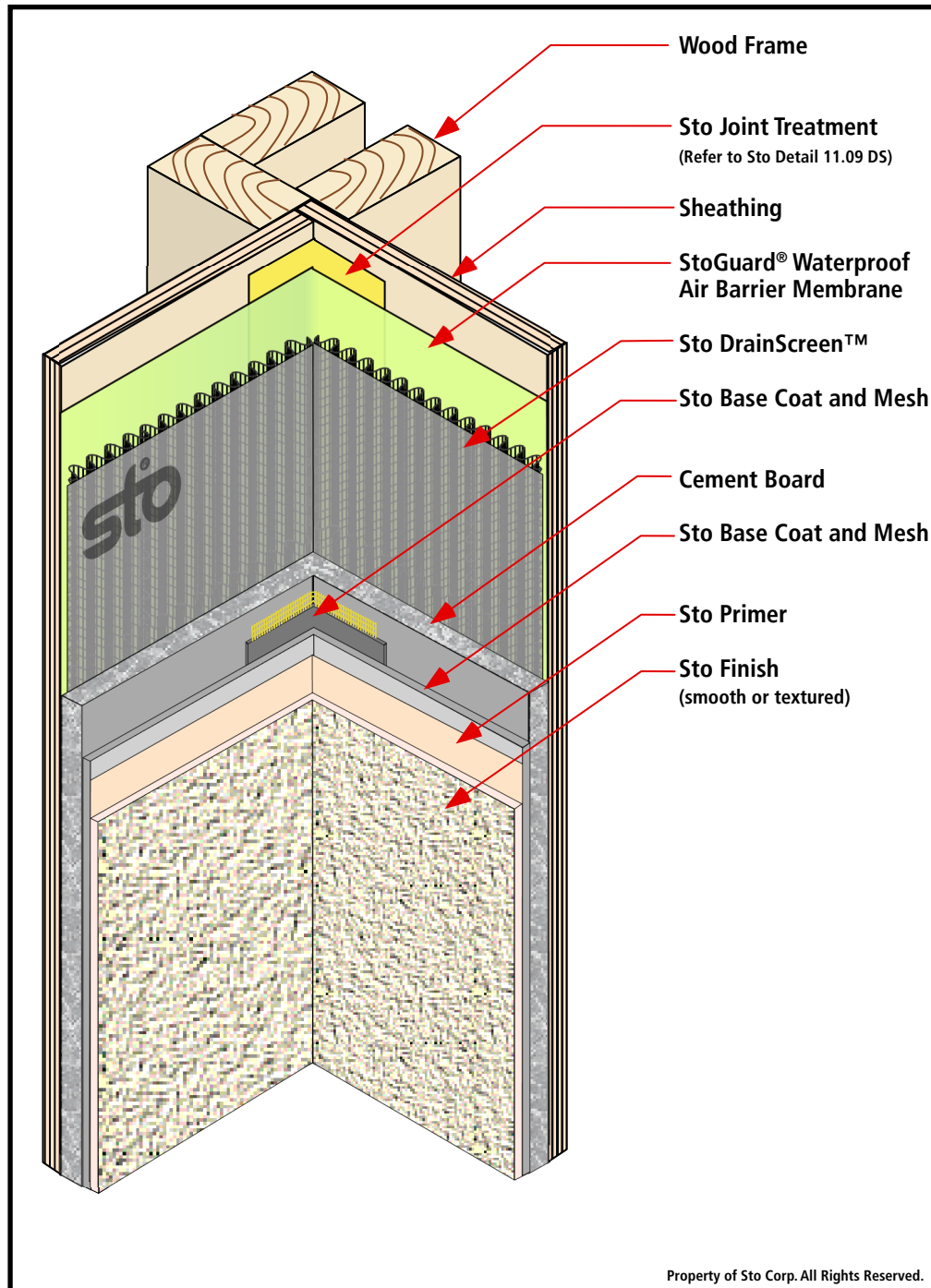

## Notes:

1. Install Sto joint treatment around inside corner. Coat entire surface with StoGuard® Waterproof Air Barrier Membrane
2. Refer to Sto Specification QS 200 DS for complete information on design requirements, installation and accessories.

IMPORTANT: Components not identified as Sto are furnished by other manufacturers and are not necessarily installed by trades who install the Sto products. Refer to project specific contract documents.

## ATTENTION

Sto products are intended for use by qualified professional contractors, not consumers, as a component of a larger construction assembly as specified by a qualified design professional, general contractor or builder. They should be installed in accordance with those specifications and Sto's instructions. Sto Corp. disclaims all, and assumes no, liability for on-site inspections, for its products applied improperly, or by unqualified persons or entities, or as part of an improperly designed or constructed building, for the nonperformance of adjacent building components or assemblies, or for other construction activities beyond Sto's control. Improper use of Sto products or use as part of an improperly designed or constructed larger assembly or building may result in serious damage to Sto products, and to the structure of the building or its components.

STO CORP. DISCLAIMS ALL WARRANTIES EXPRESSED OR IMPLIED EXCEPT FOR EXPLICIT LIMITED WRITTEN WARRANTIES ISSUED TO AND ACCEPTED BY BUILDING OWNERS IN ACCORDANCE WITH STO'S WARRANTY PROGRAMS WHICH ARE SUBJECT TO CHANGE FROM TIME TO TIME. For the fullest, most current information on proper application, clean-up, mixing and other specifications and warranties, cautions and disclaimers, please refer to the Sto Corp. website, [www.stocorp.com](http://www.stocorp.com).

[www.stocorp.com](http://www.stocorp.com)

# StoQuik® Silver DrainScreen™ Outside Corner: Common Substrate

Detail No.: 11.54 DS

Date: January 2015

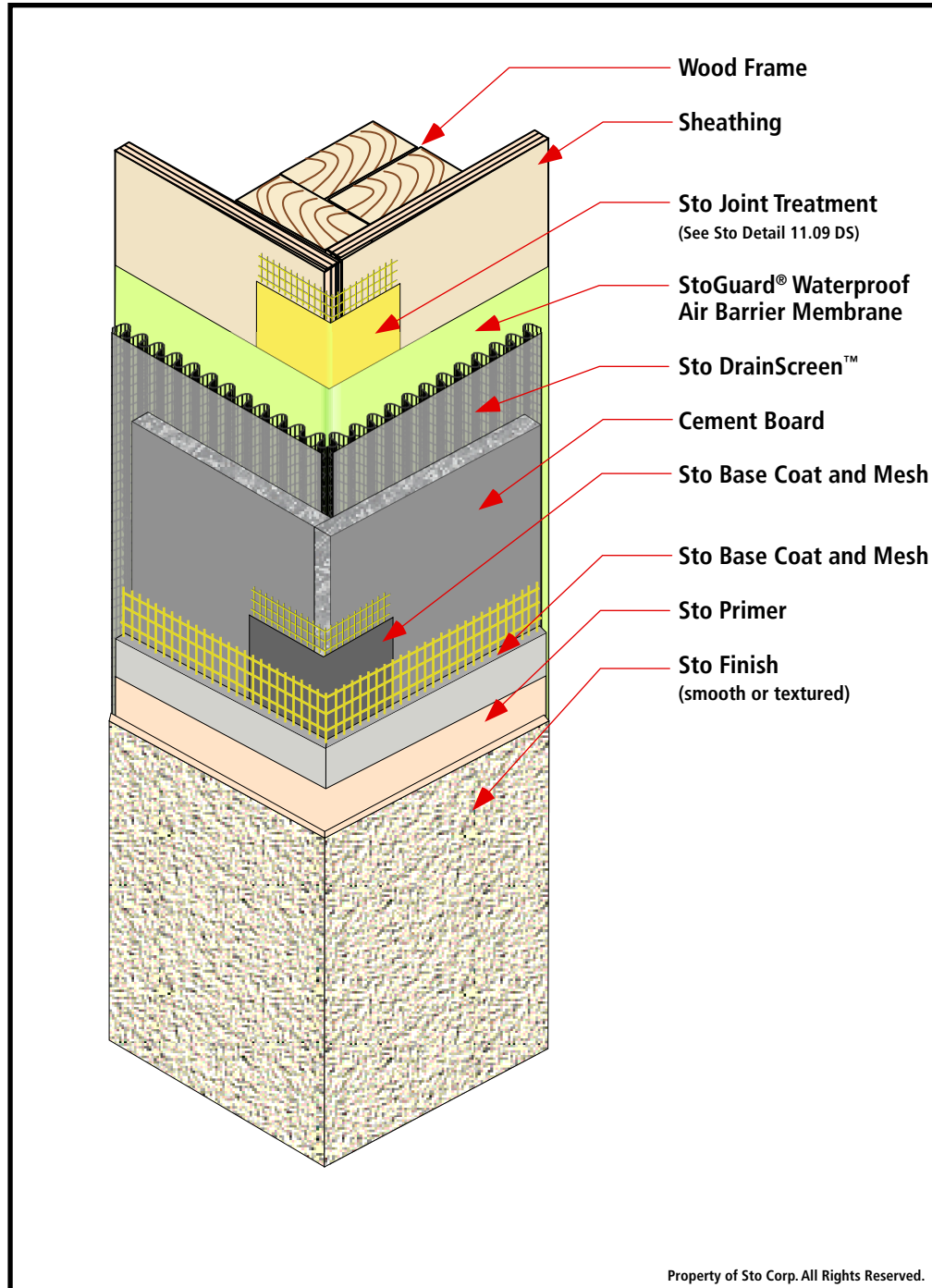

## Notes:

1. Install Sto Joint Treatment around sheathing joint at the outside corner.
2. Refer to Sto Specification QS 200 DS for complete information on design requirements, installation and accessories.

IMPORTANT: Components not identified as Sto are furnished by other manufacturers and are not necessarily installed by trades who install the Sto products. Refer to project specific contract documents.

## ATTENTION

Sto products are intended for use by qualified professional contractors, not consumers, as a component of a larger construction assembly as specified by a qualified design professional, general contractor or builder. They should be installed in accordance with those specifications and Sto's instructions. Sto Corp. disclaims all, and assumes no, liability for on-site inspections, for its products applied improperly, or by unqualified persons or entities, or as part of an improperly designed or constructed building, for the nonperformance of adjacent building components or assemblies, or for other construction activities beyond Sto's control. Improper use of Sto products or use as part of an improperly designed or constructed larger assembly or building may result in serious damage to Sto products, and to the structure of the building or its components.

STO CORP. DISCLAIMS ALL WARRANTIES EXPRESSED OR IMPLIED EXCEPT FOR EXPLICIT LIMITED WRITTEN WARRANTIES ISSUED TO AND ACCEPTED BY BUILDING OWNERS IN ACCORDANCE WITH STO'S WARRANTY PROGRAMS WHICH ARE SUBJECT TO CHANGE FROM TIME TO TIME. For the fullest, most current information on proper application, clean-up, mixing and other specifications and warranties, cautions and disclaimers, please refer to the Sto Corp. website, [www.stocorp.com](http://www.stocorp.com).

[www.stocorp.com](http://www.stocorp.com)

# StoQuik® Silver DrainScreen™ Roof/Wall Diverter Flashing

Detail No.: 11.62 DS

Date: January 2015

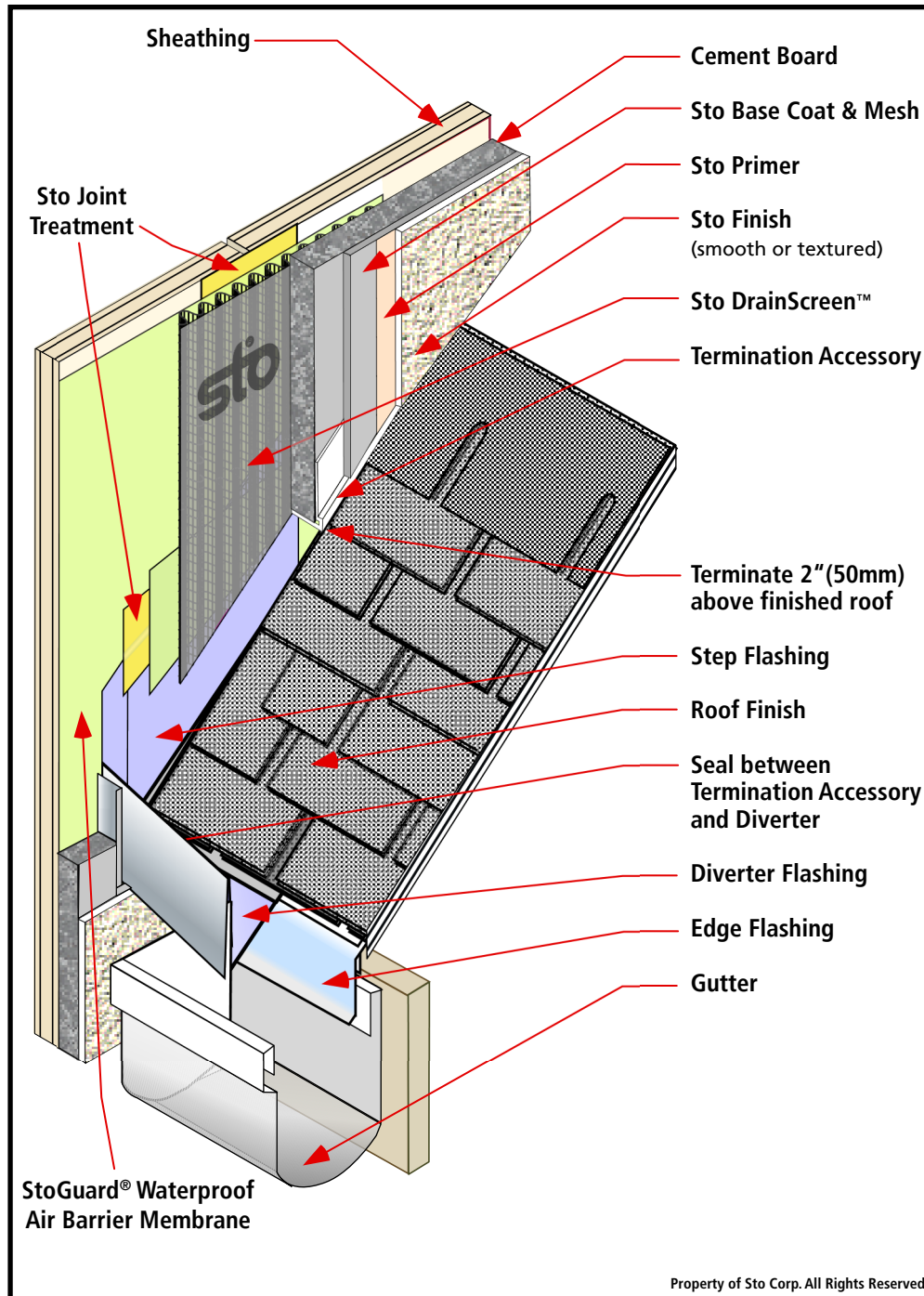

## Notes:

1. Install StoGuard® prior to installation of flashing.
2. Provide step flashing extending a minimum 4" (100mm) up the wall.
3. Provide cladding overlap of the step flashing 2" (50mm) and terminate cladding a minimum of 2" (50mm) above the finished roof. The space permits re-roofing at a future date and helps prevent debris from accumulating between roof and cladding.
4. Terminate the step flashing with a water-tight Diverter (kick-out) Flashing to direct water into the gutter.  
  
Refer to Sto Detail 2.62b on fabrication of the Diverter Flashing.
5. Provide a 3/8" (10mm) joint around the Diverter Flashing and Seal
6. Refer to Sto Specification QS 200 DS for complete information on design requirements, installation and accessories.

IMPORTANT: Components not identified as Sto are furnished by other manufacturers and are not necessarily installed by trades who install the Sto products. Refer to project specific contract documents.

Property of Sto Corp. All Rights Reserved.

## ATTENTION

Sto products are intended for use by qualified professional contractors, not consumers, as a component of a larger construction assembly as specified by a qualified design professional, general contractor or builder. They should be installed in accordance with those specifications and Sto's instructions. Sto Corp. disclaims all, and assumes no, liability for on-site inspections, for its products applied improperly, or by unqualified persons or entities, or as part of an improperly designed or constructed building, for the nonperformance of adjacent building components or assemblies, or for other construction activities beyond Sto's control. Improper use of Sto products or use as part of an improperly designed or constructed larger assembly or building may result in serious damage to Sto products, and to the structure of the building or its components.

STO CORP. DISCLAIMS ALL WARRANTIES EXPRESSED OR IMPLIED EXCEPT FOR EXPLICIT LIMITED WRITTEN WARRANTIES ISSUED TO AND ACCEPTED BY BUILDING OWNERS IN ACCORDANCE WITH STO'S WARRANTY PROGRAMS WHICH ARE SUBJECT TO CHANGE FROM TIME TO TIME. For the fullest, most current information on proper application, clean-up, mixing and other specifications and warranties, cautions and disclaimers, please refer to the Sto Corp. website, [www.stocorp.com](http://www.stocorp.com).

[www.stocorp.com](http://www.stocorp.com)

# StoQuik® Silver DrainScreen™ Saddle Flashing

Detail No.: 11.65 DS

Date: January 2015

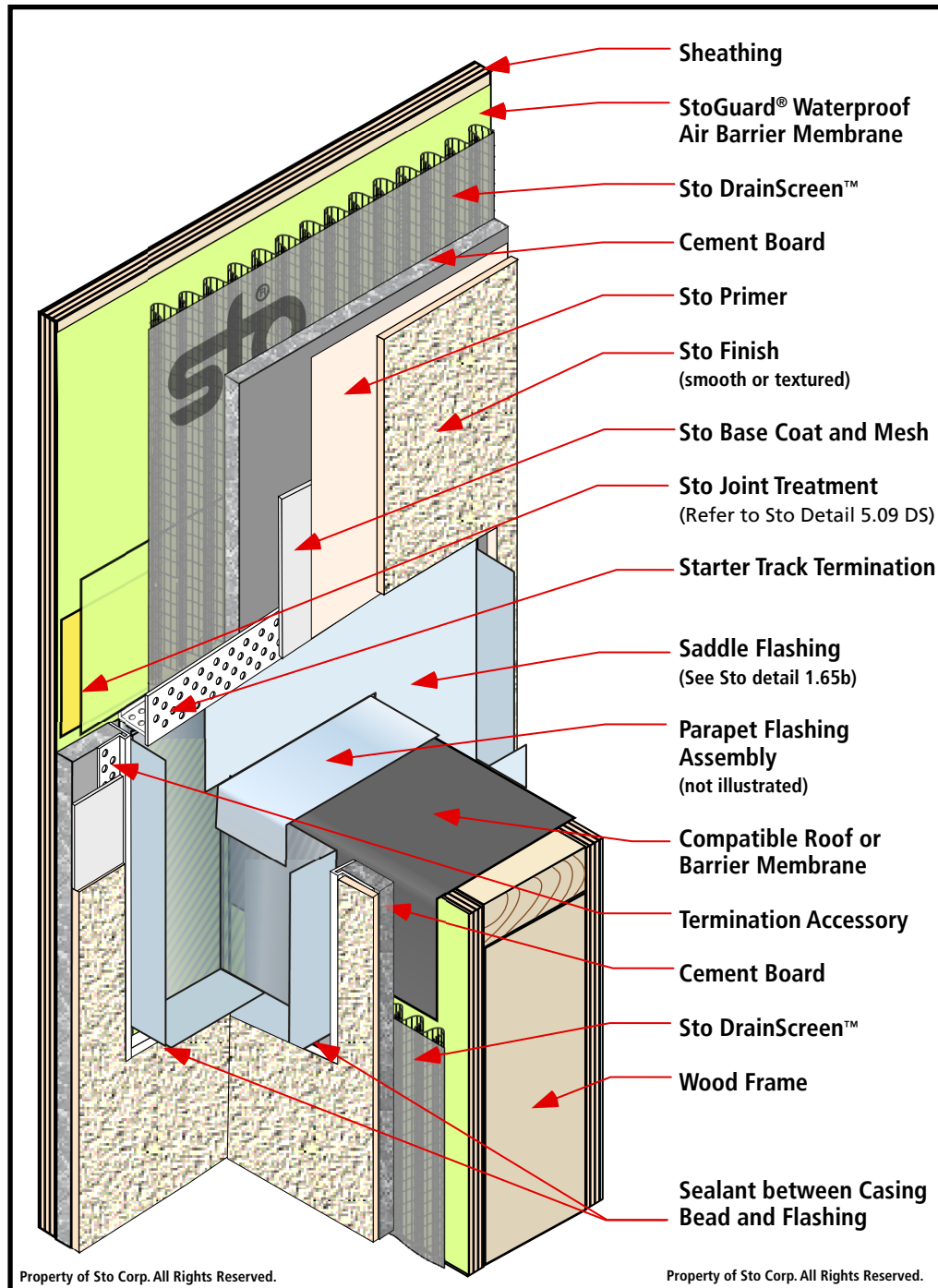

## Notes:

1. Install StoGuard® waterproof air barrier membrane behind flashing assembly integrated with compatible roof or barrier membrane over the parapet.
2. Install saddle flashing assembly.  
(Refer to Sto Detail 1.65b for Assembly of Saddle Flashing.)
3. Install Sto joint treatment over the top of the saddle flashing and back flange of starter track accessory.  
(Refer to Sto Detail 11.09 DS)
4. Lap cladding over the flashing assembly at the top a minimum of 2" (50mm) and terminate with 3/8" (10mm) joint around the perimeter.
5. Refer to Sto Specification QS 200 DS for complete information on design requirements, installation and accessories.

IMPORTANT: Components not identified as Sto are furnished by other manufacturers and are not necessarily installed by trades who install the Sto products. Refer to project specific contract documents.

## ATTENTION

Sto products are intended for use by qualified professional contractors, not consumers, as a component of a larger construction assembly as specified by a qualified design professional, general contractor or builder. They should be installed in accordance with those specifications and Sto's instructions. Sto Corp. disclaims all, and assumes no, liability for on-site inspections, for its products applied improperly, or by unqualified persons or entities, or as part of an improperly designed or constructed building, for the nonperformance of adjacent building components or assemblies, or for other construction activities beyond Sto's control. Improper use of Sto products or use as part of an improperly designed or constructed larger assembly or building may result in serious damage to Sto products, and to the structure of the building or its components.

STO CORP. DISCLAIMS ALL WARRANTIES EXPRESSED OR IMPLIED EXCEPT FOR EXPLICIT LIMITED WRITTEN WARRANTIES ISSUED TO AND ACCEPTED BY BUILDING OWNERS IN ACCORDANCE WITH STO'S WARRANTY PROGRAMS WHICH ARE SUBJECT TO CHANGE FROM TIME TO TIME. For the fullest, most current information on proper application, clean-up, mixing and other specifications and warranties, cautions and disclaimers, please refer to the Sto Corp. website, [www.stocorp.com](http://www.stocorp.com).

[www.stocorp.com](http://www.stocorp.com)



# StoQuik® Silver DrainScreen™ Foam Build-Outs

Detail No.: 11.70 DS

Date: January 2015

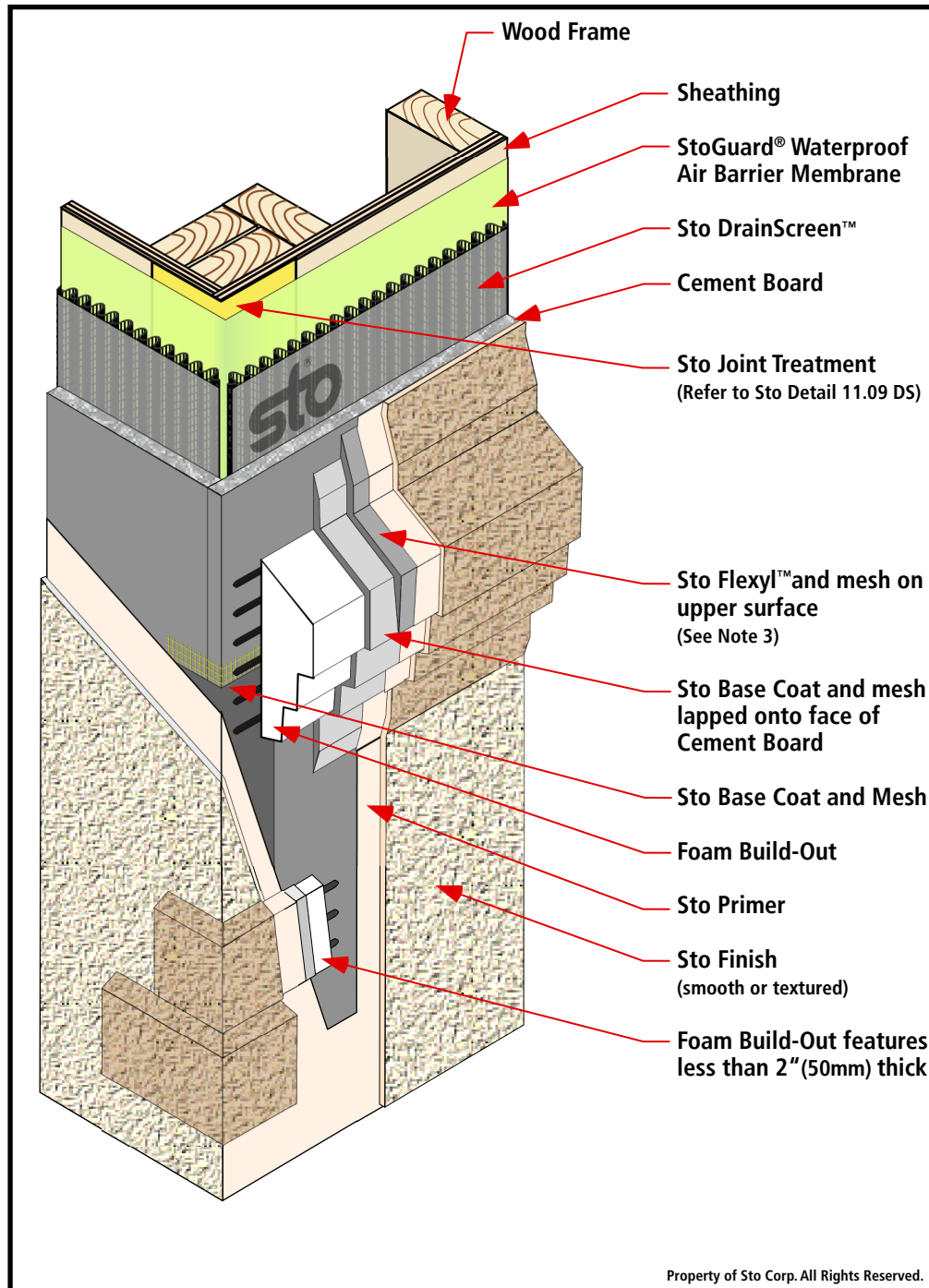

## Notes:

1. The maximum thickness of foam plastic insulation allowed by code is typically 4" (100 mm).
2. The exposed surface must have a minimum slope of 1:2 (27°). In locations where ice and snow may accumulate, increase slope.
3. Provide Sto Flexyl™ and mesh on upper surfaces of the foam build-out feature projecting more than 2" (50 mm) from the stucco surface.
4. Refer to Sto Specification QS 200 DS for complete information on design requirements, installation and accessories.

IMPORTANT: Components not identified as Sto are furnished by other manufacturers and are not necessarily installed by trades who install the Sto products. Refer to project specific contract documents.

## ATTENTION

Sto products are intended for use by qualified professional contractors, not consumers, as a component of a larger construction assembly as specified by a qualified design professional, general contractor or builder. They should be installed in accordance with those specifications and Sto's instructions. Sto Corp. disclaims all, and assumes no, liability for on-site inspections, for its products applied improperly, or by unqualified persons or entities, or as part of an improperly designed or constructed building, for the nonperformance of adjacent building components or assemblies, or for other construction activities beyond Sto's control. Improper use of Sto products or use as part of an improperly designed or constructed larger assembly or building may result in serious damage to Sto products, and to the structure of the building or its components.

STO CORP. DISCLAIMS ALL WARRANTIES EXPRESSED OR IMPLIED EXCEPT FOR EXPLICIT LIMITED WRITTEN WARRANTIES ISSUED TO AND ACCEPTED BY BUILDING OWNERS IN ACCORDANCE WITH STO'S WARRANTY PROGRAMS WHICH ARE SUBJECT TO CHANGE FROM TIME TO TIME. For the fullest, most current information on proper application, clean-up, mixing and other specifications and warranties, cautions and disclaimers, please refer to the Sto Corp. website, [www.stocorp.com](http://www.stocorp.com).

[www.stocorp.com](http://www.stocorp.com)